

# ROCKVILLE

## TITAN ARRAY SYSTEM

PRO POWERED COLUMN ARRAY  
SPEAKER w/DUAL 10" SUBWOOFERS

### OWNER'S MANUAL

**ATTENTION:**  
**WATCH THIS VIDEO BEFORE FIRST USE!**

#### *Who reads manuals?*

Scan the **QR code** or go to **rockvillesupport.com/titan-array-system** to access how-to video(s), assembly video(s), the owner's manual, and other important information you may need to get the most out of your item.

**If you prefer written instructions, please read ahead!**

*With Rockville you get many options.*



rockvillesupport.com/titan-array-system

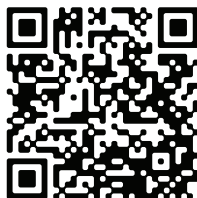

rockvillesupport.com/titan-array-system-white

**Missing items?** If you ordered a bundle that includes more than one product and you are missing part of your bundle then it just means your order shipped from two different warehouses. You will receive the remaining items very soon. If you have any concerns or inquiries, feel free to call our customer support center at 1-646-758-0144, 24 hours a day/7 days a week.

Thank you for purchasing this Rockville product. Please read this owner's manual carefully for proper use of your Titan Array System (TAS). Should you need assistance, please call our technical help line at 1-646-758-0144, 24 hours a day/7 days a week.

## Included

- Dual 10" powered subwoofer with built-in mixer and DSP
- (3) Column speakers
- Travel bag for the column speakers
- Protective cover for subwoofer
- 8-foot power cable
- Owner's manual
- Warranty card

## IMPORTANT SAFETY INSTRUCTIONS



- To reduce risk of electric shock, never open the unit. There are no user-serviceable parts; refer service to the Rockville service center.
- Do not expose this unit to any kind of moisture.
- Please ensure that the unit is situated in a properly ventilated area.
- Make sure the unit is placed on a level and stable surface.
- This unit can operate with either 110V or 220V.

## How to Avoid Irritating Feedback

The placement of your microphone is critical in avoiding feedback through your TITAN ARRAY SYSTEM speaker. Never set up your microphone in front of the speaker. Always set up your microphone behind the speaker. When approaching the speaker to make any adjustments, approach the speaker from the rear and do not walk directly toward the front of the speaker.

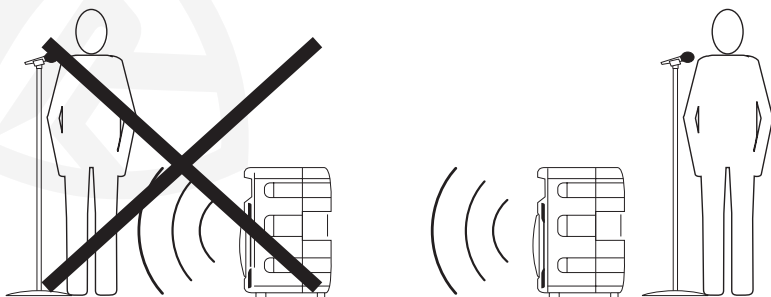

## Assembly

To assemble your system, you're going to connect all three of the array pieces onto the top of the sub. Before you begin, take a look at the bottom of the three array pieces. You'll notice that two of the arrays have round mounting tubes extending from the bottom and one has a rectangular tube extending from the bottom. This will be the first piece you connect to the sub.

The shape of the rectangular tube extending from the array (fig. a) corresponds to the port at the top of the subwoofer (fig. b). You will notice a large circular silver disc in the port and in the tube respectively. These are magnets that will help ensure the pieces remain properly connected. Turn the array until its tube's shape aligns with the port at the top of the subwoofer's cabinet (fig. c). Insert the tube and push down on the top of the array (fig. d) until you hear a little click indicating that the magnets have made contact and the array is properly connected.

Now connect the second array (fig. e), which will be the one with a mounting tube at the bottom and a connecting port at the top. Insert the tube into the port at the top of the first array, gently push down and turn it slightly, ensuring that it is properly seated. Repeat these same steps for the third and last array.

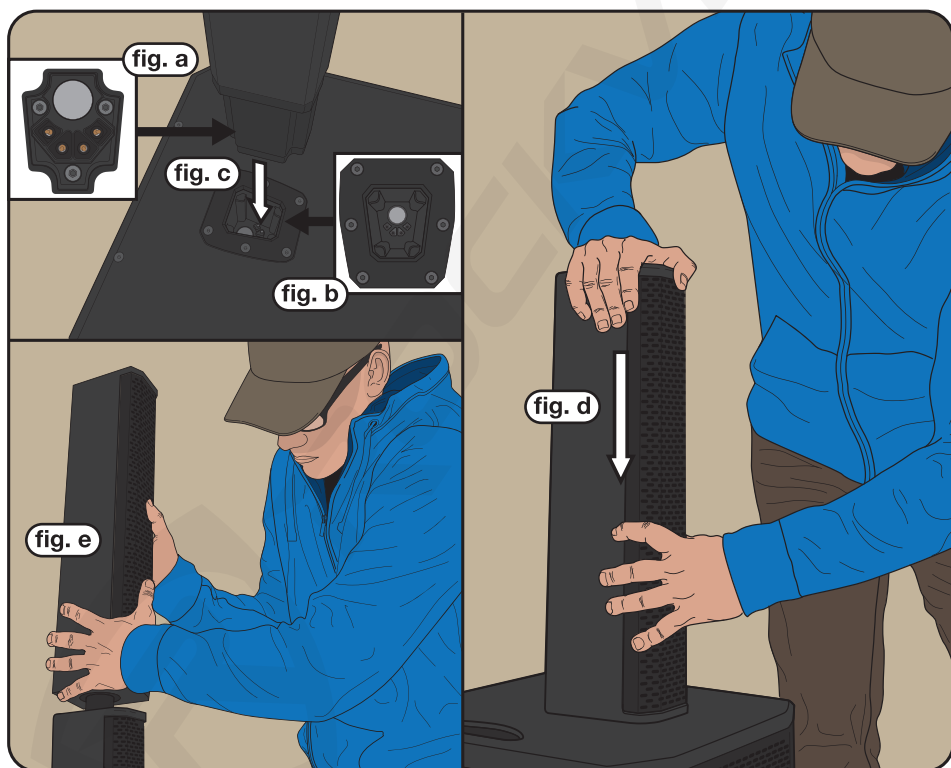

# Sound Dispersion

A cardinal rule when setting up line array sound systems is to direct the sound at the audience and not the walls or ceiling or anywhere else. With the Titan Array System you have the ability to offset the top and middle array speakers for optimal sound dispersion in most sound setup scenarios. The diagrams below are generalized examples of a single (fig. a) and dual array system (fig. b) setup. In each example, the top and middle arrays are slightly offset in order to provide the best possible sound dispersion within the performance space. Remember that these are general examples. Since every space is different, you will need to make specific tweaks to your system in order to achieve the best sound experience.

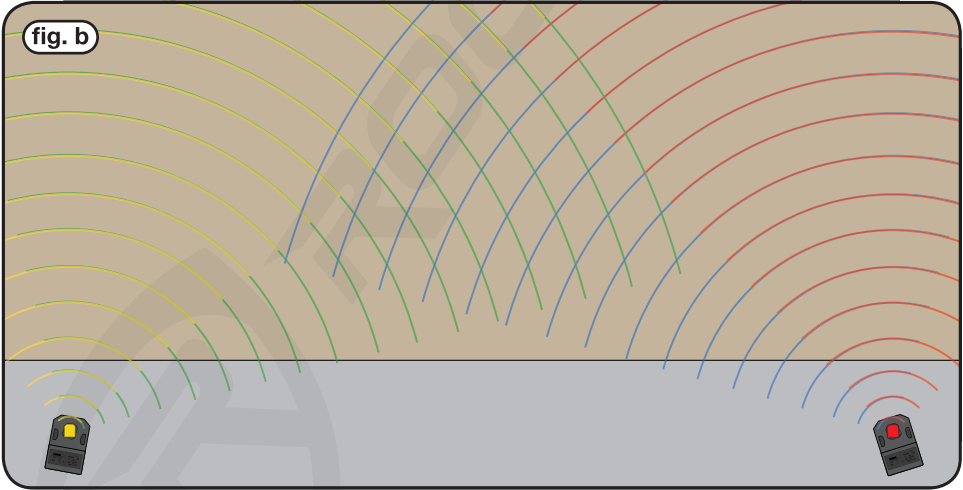
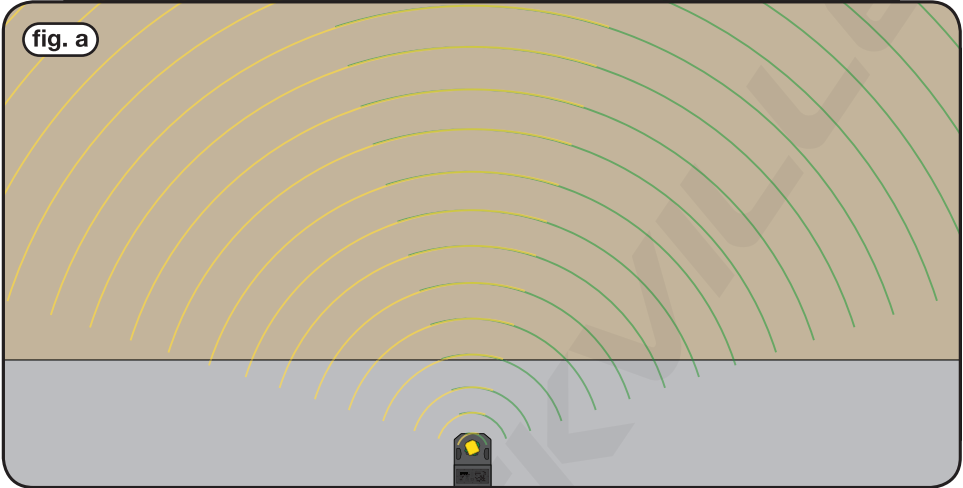

## Setting Level Controls

It is best practice to set your input volume (gains) in this manner:

1. Connect the appropriate input cable (XLR, 1/4", or RCA). In this instance we will be using the RCA line inputs.
2. Raise the line level input device's volume (smartphone, tablet, MP3 player, etc.).
3. Set the LINE/MP3 LEVEL control to  $-\infty$  (infinity).
4. Set the power switch to ON.
5. Slowly turn up the LINE/MP3 LEVEL control (a). As soon as the CLIP indicator LED goes on (b) or you hear any distortion, turn LINE/MP3 LEVEL down one or two notches (c).

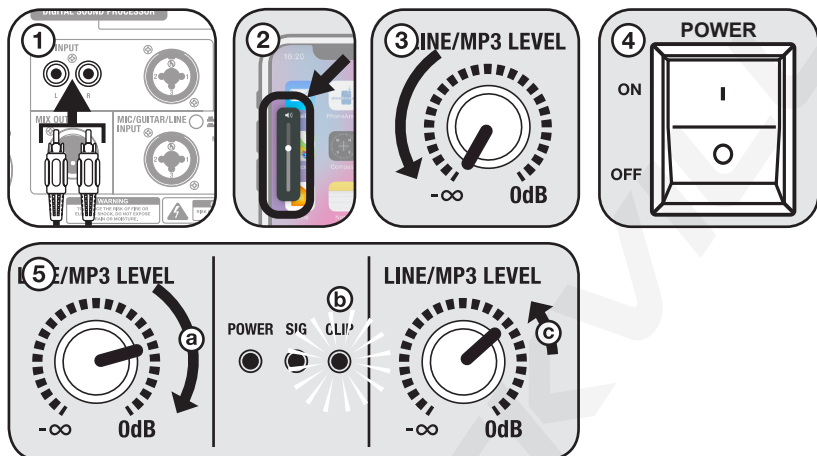

### ! PLEASE NOTE

A. The TAS's clip LED responds to the overall output from all the channels. That means that if multiple input sources are connected, you may have to individually adjust each input in order to stop clipping.

B. Because mixers feature two volume controls (channel and master), when connecting one via the line input, the procedure is slightly different. Set the TAS's LINE LEVEL control to 50% and set your mixer's master volume to 50%. Make the adjustments in step 3 on the mixer channel level control. If after making these adjustments the signal still isn't strong enough, you can additionally boost the signal by turning up the appropriate LINE LEVEL control on the TAS.

C. When adjusting the MIC/GUITAR/LINE LEVEL control, you must speak into the microphone and adjust the control as needed. This is because adjustments to the mic input are a matter of mic sensitivity/volume in relation to the music volume and not necessarily a clipping issue.

## Microphone/Guitar Input

Your TAS features a balanced microphone input accessible via a combo XLR/1/4" TRS input.

1. Switch OFF your TAS.
2. Plug in your microphone or guitar into the jack marked MIC/GUITAR/LINE INPUT using an XLR or 1/4" TRS cable.
3. Switch ON your TAS. Set the MIC/GUITAR/LINE selector button to MIC/GUITAR.
4. Refer to the "Setting Level Controls" section of this manual for instructions on how to properly adjust the input volume (gains).

Always stand behind the TAS when making your microphone adjustments to avoid feedback distortion.

## Line Input

You can connect an additional signal source such as CD players, DVD music players, MP3 players, headphones, DJ mixers and controllers, etc. Plug the device directly into the combo XLR/ ¼" TRS input in the LINE INPUT section, the RCA jacks in the LINE INPUT section, or the combo XLR/ ¼" TRS input in the MIC/GUITAR/LINE INPUT section. When using this input, make sure the MIC/GUITAR/LINE selector button is set to LINE.

### XLR/¼" TRS Input

1. Switch OFF your TAS.
2. Connect the music source to the combo XLR/¼" TRS input in the LINE INPUT section or the combo XLR/¼" TRS input in the MIC/GUITAR/LINE section (preferred) using an XLR or ¼" cable. Please note, if using the MIC/GUITAR/LINE combo input, make sure the MIC/GUITAR/LINE selector switch is set to LINE.
3. Switch ON your TAS.
4. Refer to the "Setting Level Controls" section of this manual for instructions on how to properly adjust the input volume (gains).

### RCA Input

1. Switch OFF your TAS.
2. Connect the music source to the RCA jacks in the LINE INPUT section.
3. Switch ON your TAS.
4. Refer to the "Setting Level Controls" section of this manual for instructions on how to properly adjust the input volume (gains).

## Wireless Streaming

To connect your iPod, iPhone, MP3 player, Android phone, or any other Wireless streaming-capable device, follow the steps listed below. Refer to the Functions section for playback controls. If you have problems pairing your device, please check the troubleshooting guide.

1. Switch ON your TAS and it will automatically enter BT mode. The LCD display will read "Bluetooth Unconnected." If the unit does not go into BT mode, press the MODE button to select BT mode.
2. Turn on the Wireless streaming feature on your device and ensure that it is discoverable.
3. Look for "TITAN ARRAY SYSTEM" on the list of available devices and select it.
4. Once paired, the LCD display will read "Bluetooth Connected." The TAS unit will remember the last paired device. When the unit is in BT mode and the device is nearby, it will connect to it automatically.
5. To disconnect a device, press and hold the PLAY/PAUSE button.

Please note, if you are using two Titan Array Systems they will connect to each other via TWS if powered on simultaneously.

## True Wireless Stereo (TWS) Speaker Linking

The TAS features True Wireless Stereo (TWS) linking via Wireless streaming. This means you can purchase two of these speakers and link them to play wirelessly in stereo.

1. Simultaneously turn on both Titan Array Systems. They will automatically connect to each other. Initially the LCD displays of both units will read "Bluetooth Unconnected." Once they are paired, one unit's LCD display will read "Bluetooth TWS Connected". This unit will act as the left channel. The other unit's LCD display will read "Bluetooth TWS Unconnected." This unit will act as the right channel.
2. Turn on the Wireless streaming feature on your device and ensure that it is discoverable. Look for "TITAN ARRAY SYSTEM" on the list of available devices and select it.

## True Wireless Stereo (TWS) Speaker Linking (continued)

4. Once paired, the LCD displays on both units will read "Wireless streaming TWS Connected."
5. Volume is controlled via the LINE/MP3 LEVEL control knob. There is a secondary volume control via the MP3 module's previous and next buttons (◀◀/▶▶). They will sync with your phone's volume control, meaning that if you press and hold either of the buttons, they will adjust the volume on your phone and vice-versa. All other functions, such as playback and track selection, can be controlled by either unit,
6. To exit TWS linking mode, press and hold either unit's MODE button for 3 to 5 seconds.

## USB/SD Input

For USB/SD playback, insert an SD card or USB flash drive. The unit will automatically begin playback. Please note, when an SD card or USB flash drive is inserted, it will override all other input modes. Accepted formats are MP3, WMA, WAV, and WMF. Refer to the Functions section for playback controls.

### Folders

To navigate folders within your SD card or USB drive, follow the steps below.

1. Press and hold the PLAY/PAUSE button to access folders.
2. Use the PREVIOUS/NEXT buttons to navigate the folders. When you stop on a folder, the first track in that folder will automatically begin to play. If you do not press previous next, the TAS will play all the tracks within that folder.

## Mix Out Balanced Connection

The MIX OUT XLR port allows you to output the amplifier signal to a subwoofer, another powered speaker, or an amp or mixer, which will, in turn, power other speakers. The MIX OUT output should be connected to the input of the external device using an XLR-to-XLR or XLR-to-1/4" TRS cable. We recommend you use high-quality cables such as Rockville's RCXFM20E-B XLR-to-XLR cable or the RCXMB20-B XLR-to-1/4" TRS cable.

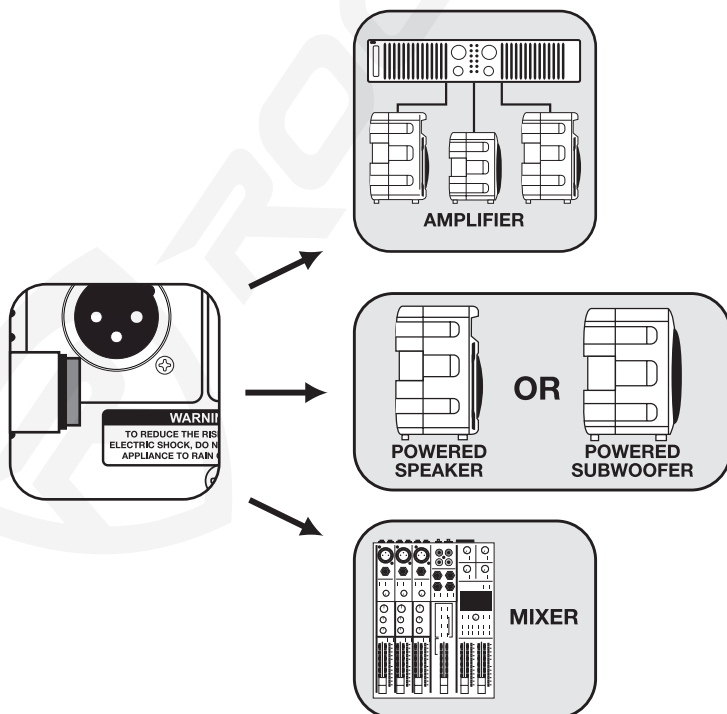

# Functions

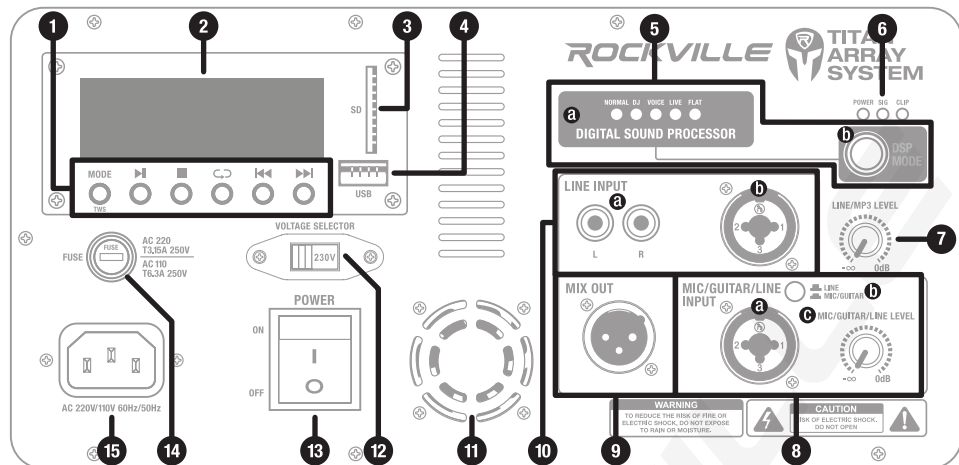

## 1. MP3 Player controls

- **MODE/TWS linking:** Press to switch modes (USB/SD and BT). Press and hold in BT mode to activate TWS linking mode. Press and hold in USB/SD mode to turn off the MP3 module.
- **▶ (PLAY/PAUSE):** Press button once to play track; press again to pause (all modes). In USB/SD mode, press and hold to enter folders. In BT mode, press and hold to disconnect the current device.
- **■ (STOP):** Press to stop music playback.
- **↺ (REPEAT, USB/SD MODE ONLY):** Continuously press to cycle through single (repeats the current track), folder (repeats all tracks within a folder), random (repeats tracks in random order), and repeat all.
- **⏮/⏭ (PREVIOUS/NEXT):** Press to select tracks in USB, SD, and BT mode. Press and hold to adjust volume. In BT mode, the output device's volume controls will sync with these volume controls.

## 2. LCD display

## 3. SD input

## 4. USB input

## 5. DSP section

- DSP MODE LED indicators
- Turn to switch DSP modes.

## 6. POWER LED indicator: illuminates when the unit is receiving power

**SIG LED indicator:** illuminates when receiving signal from the LINE INPUT, MP3, or MIC/GUITAR/LINE INPUT sections

**CLIP LED indicator:** illuminates when there is a power overload. This indicates that limiting has taken place to protect and avoid damage to the amplifier or speaker. Continuously over driving the system will cause distortion and may cause damage to the amplifier and/or the speaker.

## 7. LINE/MP3 level control

## 8. MIC/GUITAR/LINE INPUT section (preferred)

- Combo XLR/1/4" TRS input
- MIC/GUITAR/LINE selector switch: When connecting a microphone or guitar, make sure that the Line/Mic/Guitar button is in the "down" position. When connecting a line level device, make sure that the specific button is in the "up" position.
- MIC/GUITAR/LINE LEVEL input control.

## 9. MIX OUT port

10. LINE INPUT/MP3 section
  - a. RCA input
  - b. Combo XLR/¼" TRS input
11. Exhaust fan
12. VOLTAGE selector switch
13. POWER switch
14. FUSE compartment
15. IEC AC input port

## Features

- 3200W peak power/1600W program power/800W RMS (continuous)
- One system is loud enough for 300 people in a 10k-square-foot space
- Wireless stereo linking (TWS) of two systems
- Bluetooth 5.0 chip allows crystal-clear music streaming with 65-foot max range
- USB playback (32GB max)
- SD playback (32GB max)
- Input 1: Mic/Guitar/Line level XLR/¼" combo jack
- Input 2: Line level input XLR/¼" combo jack
- Line level RCA inputs
- XLR Mix output allows you to connect another speaker or amplifier
- Class D amplifier is extremely efficient with a low current draw, and approximately 90% of energy is turned into clean amplifier power
- Limiter allows the speaker to play at extremely high volumes while limiting the frequencies that cause clipping
- LOWS: Dual 10" subwoofers (500W RMS to the lows) with large 80oz magnets and 2" OFC voice coils
- HIGHS: Ten 3.5" drivers with neodymium magnets (2 x 150W RMS to the highs)
- All components are in wooden enclosures and deliver crystal-clear sound quality even at max volume levels
- 0.6"-thick MDF sub enclosure with sandblasted paint
- Each column speaker can rotate 360°, allowing for efficient sound dispersion
- Built-in user-adjustable DSP modes (Normal, DJ, Voice, Live, Flat)
- DSP tuned by Rockville musicians for extremely balanced sound with clear vocals, deep heart-thumping bass, and crystal-clear instruments and highs
- Wide angle sound dispersion fills a room with sound
- Built-in dual carry handles on the subwoofer unit
- Frequency Response: 30Hz – 20kHz
- Maximum SPL: 127dB
- Voltage: 110/220 voltage switch for worldwide use
- Weight of sub: 61.73lbs.
- Dimensions of sub: 20.68" x 14.9" x 21.8"
- Weight of each column: 5.78lbs.
- Dimensions of each column: 5.32" x 3.94" x 19"
- Available in Black or White

## Troubleshooting

PROBLEM	SOLUTION
No power	<ol style="list-style-type: none"> <li>1. Make sure the unit is plugged in and the power switch is in the ON position.</li> <li>2. Check that the power cable is plugged in tightly to the unit.</li> <li>3. Check and replace the fuse if necessary.</li> <li>4. If people or equipment tend to step on and roll over or stretch your power cable, it can get damaged. Always try a second cable to test for shorts in original cable. Dispose of damaged power cables immediately.</li> </ol>
No sound/ distorted sound	<ol style="list-style-type: none"> <li>1. Check that all appropriate cables are plugged in correctly.</li> <li>2. Make sure the arrays are properly connected. Refer to the assembly instructions on page 3.</li> <li>3. Check the Levels settings. Refer to the “Setting Level Controls” section on page 5 of this manual for instructions on how to properly adjust the input level controls.</li> <li>4. If you are using the MIC/GUITAR/LINE section inputs, make sure the MIC/GUITAR/LINE button is set to the correct input source.</li> <li>5. Be sure your microphone is on and plugged into the correct input.</li> <li>6. If using a mixing console, make sure fader and balance are set to center positions and levels are increased. Make sure the mixer is plugged into the correct input.</li> <li>7. If channel levels settings are maxed out, turn down the appropriate one, as you may be over driving the unit.</li> <li>8. Check volume and level settings on all input sources.</li> <li>9. Check the MP3 module volume controls (in USB/SD/BT modes, press and hold the PREVIOUS/NEXT buttons to adjust the volume up or down).</li> </ol>
Buzzing sound	Make sure you are using a proper cable. For ¼” cables, there are three types: instrument, TS (unbalanced), and TRS (balanced). Check the requirements of the connected gear and make sure you are using the appropriate cable.
Mic feedback	Point the mics away from the speaker. Make sure the mics are behind the speaker, not in front of it.
Poor mic sound	Make sure you are using the XLR part of the Mic/Guitar/Line port
Wireless streaming pairing/TWS linking fails	<ol style="list-style-type: none"> <li>1. Check to see that both devices are turned on and that your Wireless streaming device is discoverable.</li> <li>2. Turn both devices off and then on.</li> <li>3. Make sure you’ve selected the proper source.</li> <li>4. Make sure that the Wireless streaming device is within 5 feet of the unit (during initial pairing).</li> <li>5. Move both devices away from other Wireless streaming devices, microwaves, wireless routers, and other electronics.</li> <li>6. Make sure that the unit is not paired to a previously paired device or to another speaker.</li> </ol> <p><b>Please refer to page 6 -7 for Wireless streaming and TWS linking pairing procedures.</b></p>

## FEDERAL COMMUNICATIONS COMMISSION COMPLIANCE INFORMATION

Responsible party name: Rockville

Address: 600 Bayview Ave,  
Entrance A,  
Inwood, NY 11096

Hereby declares that the product(s) TITAN ARRAY SYSTEM and TITAN ARRAY SYSTEM WHITE complies with FCC rules as mentioned in the following paragraph:

This device complies with Part 15 of the FCC rules. Operation is subject to the following two conditions: (1) this device may not cause harmful interference, and (2) this device must accept any interference received, including interference that may cause undesired operation.

Note: This equipment has been tested and found to comply with the limits for a Class B digital device, pursuant to Part 15 of the FCC rules. These limits are designed to provide reasonable protection against harmful interference in a residential installation. This equipment generates, uses, and can radiate radio frequency energy and, if not installed and used in accordance with the instructions, may cause harmful interference to radio communications. However, there is no guarantee that interference will not occur in a particular installation. If this equipment does cause harmful interference to radio or television reception, which can be determined by turning the equipment off and on, the user is encouraged to try to correct the interference by one or more of the following measures:

- Reorient or relocate the receiving antenna.
- Increase the separation between the equipment and receiver.
- Connect the equipment to an outlet on a circuit different from that to which the receiver is connected.
- Consult the dealer or an experienced radio/TV technician for help.

***ROCKVILLE***

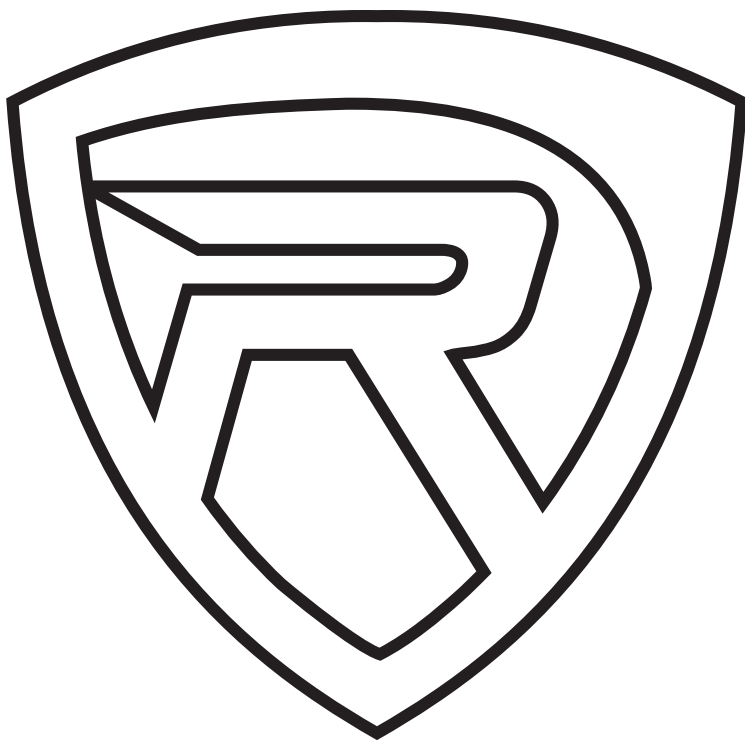

**RockvilleAudio.com**

© 2024 ROCKVILLE // Features and specifications are subject to change and/or improvement without notice.