

ROCKVILLE

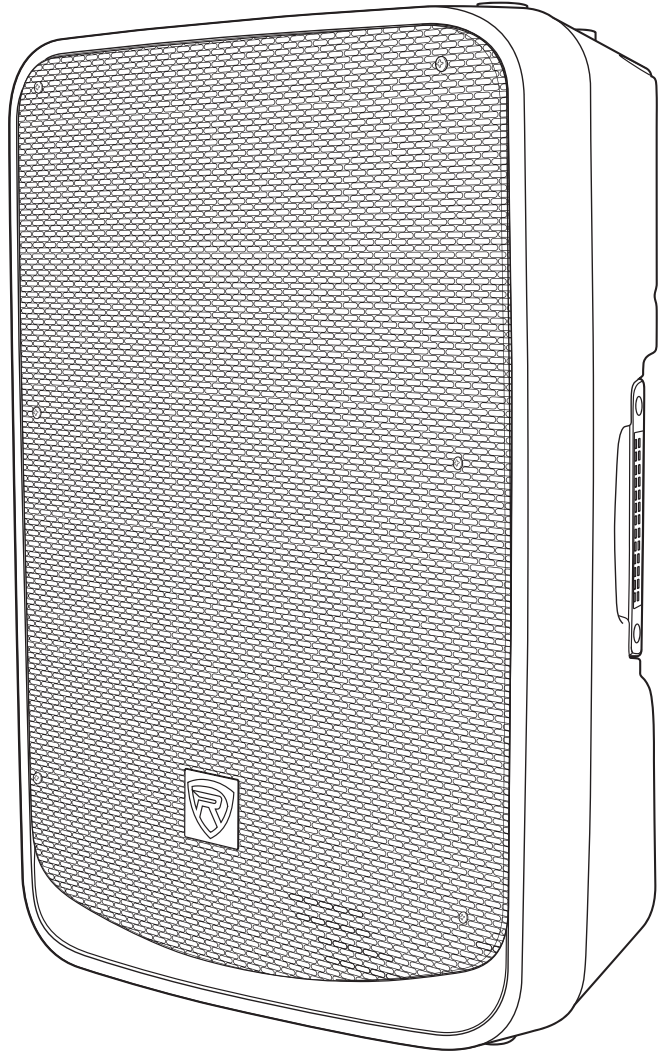

OWNER'S MANUAL

TITAN 12

12" 2000W POWERED PA SPEAKER
w/BLUETOOTH, DSP & WIRELESS LINKING

Rockwell

Thank you for purchasing this Rockville TITAN 12 12" Powered PA Speaker w/Bluetooth, DSP, and Wireless Linking. Please read this owner's manual carefully for proper use of your TITAN 12. Should you need technical assistance during or after your installation, please call our technical help line at 1-646-758-0144, Monday through Friday, 9am to 5pm EST.

Included

- (1) 12" speaker
- (1) 10-foot power cable
- Manual
- Warranty card

IMPORTANT SAFETY INSTRUCTIONS



- To reduce risk of electric shock, never open the unit. There are no user-serviceable parts. Refer service to an authorized Rockville service center.
- Do not expose this unit to any kind of moisture.
- Please ensure that the unit is situated in a properly ventilated area.
- Make sure the unit is placed on a level and stable surface.

How to Avoid Irritating Feedback

The placement of your microphone is critical in avoiding feedback through your TITAN 12 speaker. Never set up your microphone in front of the speaker. Always set up your microphone behind the speaker. When approaching the speaker to make any adjustments, approach the speaker from the rear and do not walk directly towards the front of the speaker.



Setting Level Controls

It is best practice to set your input level controls in this manner:

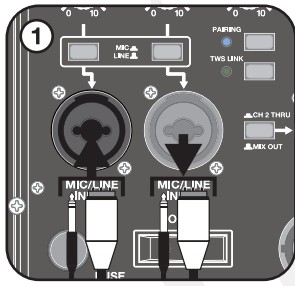

1. Unplug all inputs except for the one you wish to set the level for. In this instance, it is the CH1 Mic/Line TRS and 1/4" combo input. Make sure the Mic/Line button is set to Line (the "up" position).

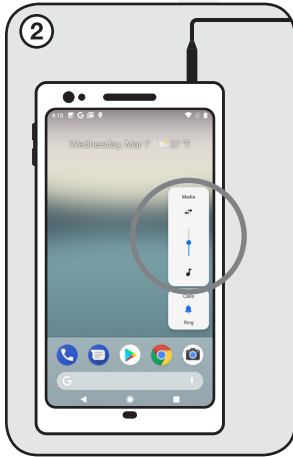

2. Set the line level input device volume (smartphone, tablet, MP3 player, etc.) at 65% – 75%.

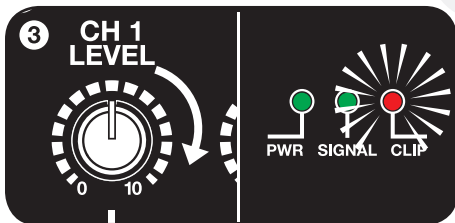

3. Slowly turn up the level on the selected input (in this case, the CH1 level). As soon as the clip indicator LED goes on or you hear any distortion, turn it down one or two notches.

After you set the levels on all input devices, you can readjust the TITAN 12 levels as necessary.

! PLEASE NOTE

Because mixers feature two volume controls (channel and master), when connecting one via the XLR Line In port, the procedure is slightly different. The TITAN 12 Channel Level control should be set to 50%. Set the mixer master volume to 50% and make the adjustments in Step 3 on the mixer channel level control. If after making these adjustments the signal still isn't strong enough, you can additionally boost the signal by turning up the Mic/Line Level control.

When adjusting the CH1/CH2 Level controls, you must speak into the microphone and adjust the level control as needed. This is because adjustments to the mic input are a matter of mic volume in relation to the music volume and not necessarily a clipping issue.

APPLICATION USES

Microphone Presentations

Your TITAN 12 features ultra-low noise Mic/Line inputs via combo XLR/¼" TRS stereo jacks.

1. Make sure the Power switch is in the OFF position.
2. Plug your microphone into either the XLR or ¼" jack input of the combo jack. Make sure the Mic/Line switch is set to Mic (the "down" position).
3. Switch on the TITAN 12.
4. Refer to the "Setting Level Controls" section of this manual for instructions on how to properly adjust the Mic Level controls.

If using a second microphone, connect the microphone to the CH2 Mic/Line Input and follow the procedure detailed above. Always stand behind the TITAN 12 when making your microphone adjustments to avoid feedback.

Line Input

You can use the Mic/Line In combo XLR/¼" inputs to connect a mixer or to connect an additional stereo signal source such as a smartphone, tablet, MP3 player, CD player, etc.

1. Make sure the Power switch is in the OFF position.
2. Connect the mixer to the XLR input or a line level signal source to the ¼" input. Make sure the Mic/Line switch is set to Line (the "up" position).
3. Switch on the TITAN 12 unit.
4. Refer to the "Setting Level Controls" section of this manual for instructions on how to properly adjust the input level controls.

Thru/Mix Connection

The THRU/MIX XLR port allows you to output the amplifier signal to a subwoofer, another powered speaker, or an amp or mixer that will, in turn, power other speakers. You can choose to send the entire mix or just the output of CH2 by pressing the selector button located next to the port. The THRU/MIX output should be connected to the input of the external device using an XLR to XLR or XLR to ¼" TRS cable. We recommend you use high-quality cables such as Rockville's RCXFM20E-B XLR to XLR cable or the RCXMB20-B XLR to ¼" TRS cable.

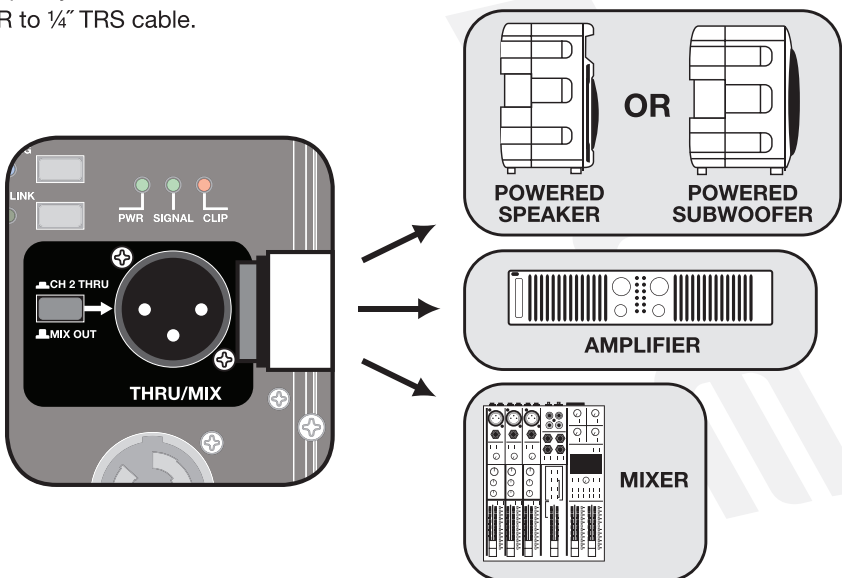

Wireless Speaker Linking

The TITAN 12 features true wireless stereo (TWS) Bluetooth linking. This means you can purchase two of these speakers and link them together to play in stereo wirelessly.

1. Make sure both TITAN 12 units' power switches are in the OFF position.
2. Go to your phone's Bluetooth interface and make sure that it is not connected to either TITAN 12 unit (2a). If your phone is connected, choose to forget or remove the TITAN 12 unit(s) from the list of available devices (2b).
3. Turn both speakers ON (3a). Press the PAIRING button on either one of the units (3b). The PAIRING LED will flash slowly. Repeat this step for the other unit.
4. Press the TWS button on both units for 1 second. The TWS LED on both units will flash quickly. Once the units are successfully paired, the LEDs will stop flashing and remain lit.
5. Press the PAIRING button on one of the units for 1 second to activate Bluetooth pairing mode. The PAIRING LED will flash quickly.
6. Go to your phone's Bluetooth interface and select "TITAN 12" from the list of available devices. If pairing is successful, the PAIRING LED will stop flashing and remain lit. This unit will be the Primary and will control all functions for both units.
7. To disconnect the speakers, press the TWS button on either unit for 1 second.

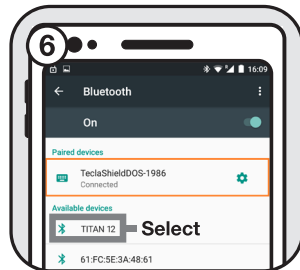
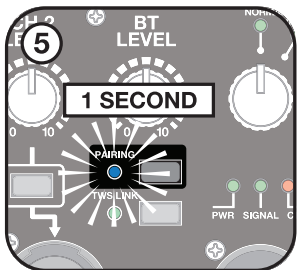
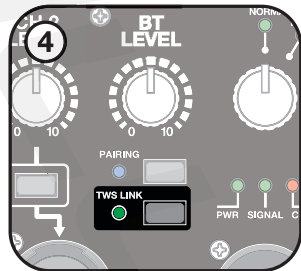
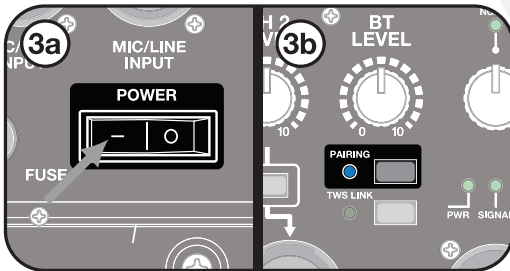
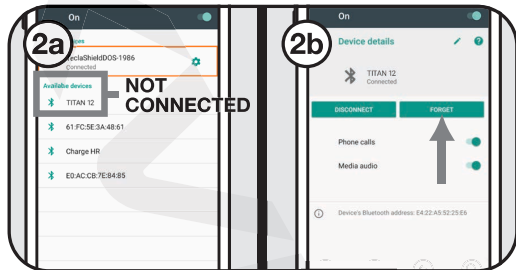
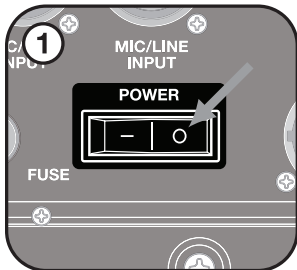

Bluetooth

To connect any Bluetooth-capable device, follow the steps listed below.

1. Make sure the TITAN 12 unit's power switch is in the ON position.
2. Turn on the Bluetooth feature on your device and ensure that it is discoverable.
3. Press the PAIRING button for 3 seconds to activate Bluetooth-pairing mode. The PAIRING LED will flash slowly.
4. Press the PAIRING button for 1 second. The PAIRING LED will flash quickly.
5. Go to your device's Bluetooth interface and select "TITAN 12" from the list of available devices. If pairing is successful, the PAIRING LED will stop flashing and remain lit.
6. Use the BT LEVEL control to adjust the volume of input from the paired Bluetooth device.
7. To end the Bluetooth connection, follow your device's procedure for disconnecting from a paired device.

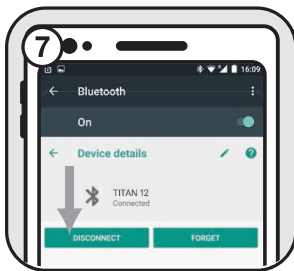
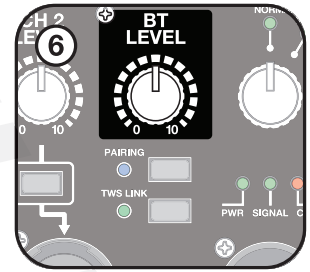
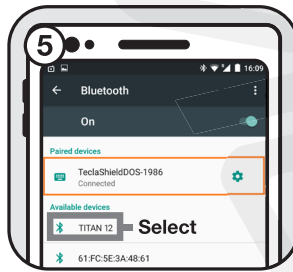
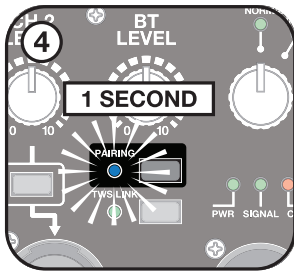
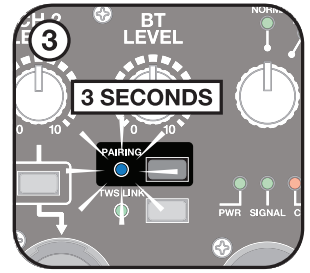
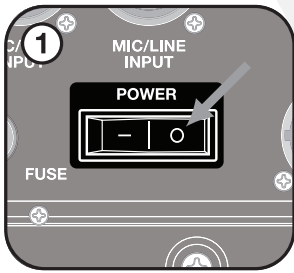

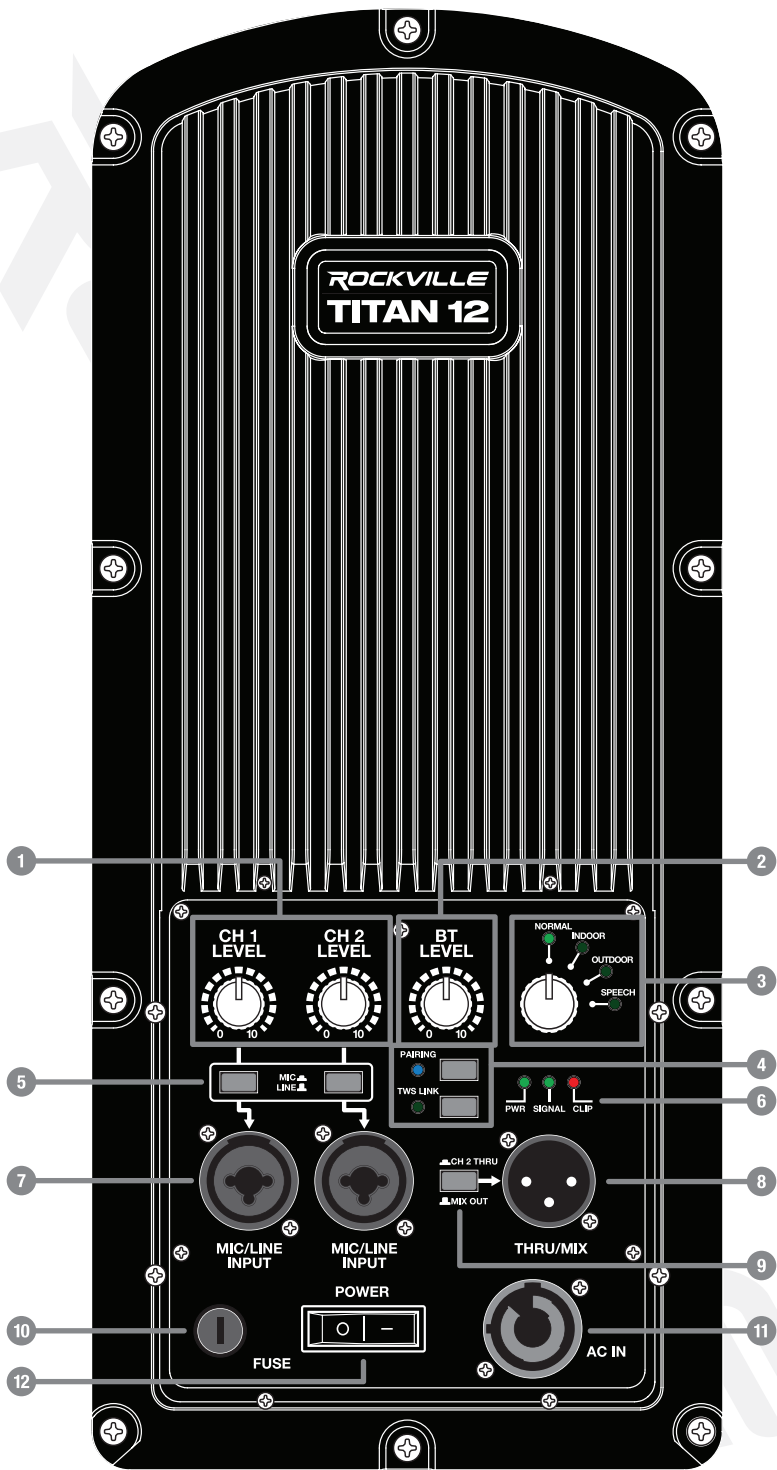

Functions

1. **CH1/CH2 Input Level Controls:** used to control the volume of the Mic/Line inputs. When the THRU/MIX switch is set to MIX OUT, they control the mix output.
2. **BT Level Control:** adjusts the volume of Bluetooth input.
3. **EQ Control:** EQ settings are designed around the purpose of tuning the speaker for the environment in which you are using it. They are variations of the Normal speaker setting with a few minor variations to boost certain frequencies:
 - Normal** - “flat” speaker setting which will suit most normal listening environments.
 - Indoor** - subtle low-mid frequency and high-mid boost frequency.
 - Outdoor** - subtle high-frequency boost.
 - Speech** - subtle high-pass frequency and mid-frequency boost.
4. **Bluetooth Pairing and TWS Link Buttons:** These buttons will allow for usage of the Bluetooth and TWS functions. For detailed directions on how to use either one of these functions, please refer to pages 6 and 7 of this manual.
5. **Mic/Line Switch:** This switch corresponds to the Mic/Line inputs. When connecting a microphone, make sure that the specific Line/Mic button is in the “down” position. When connecting a line level device, make sure that the specific button is in the “up” position.
6. **Power LED Indicator:** will illuminate when the unit is receiving power.
Signal LED Indicator: will illuminate when the unit is receiving a signal from the CH1, CH2, or Bluetooth inputs.
Clip LED Indicator: will illuminate when there is a power overload. It indicates that limiting has taken place to protect and avoid damage to the amplifier or speaker. Continuously over driving the system will cause distortion and may cause damage to the amplifier and/or the speaker.
7. **Combo XLR/¼” Ports:** accept XLR-type connectors and balanced/unbalanced ¼” TRS/TS plugs. When you use an unbalanced ¼” TS plug, the line input automatically turns the ring into ground.
8. **THRU/MIX Out XLR Port:** For detailed directions on how to use this port, please refer to page 5 of this manual.
9. **CH2 THRU/MIX Switch:** used to determine the signal output of the THRU/MIX port. Please refer to page 5 of this manual for further details.
10. **250V/6.3A User-Serviceable Fuse**
11. **AC In Power Connector:** input PowerCON connector.
12. **Power Switch**

Specifications

- Rockville TITAN 12 12" Active/Powered 2,000 Watts DJ/PA Speaker System
- 500 watts true RMS/1,000 watts program power/2,000 watts peak
- High-power long-throw 12" woofer with 3" OFC copper voice coil and a 60-Oz. magnet
- Frequency response: 40Hz – 20KHz
- Maximum SPL @1w/1m: 128dB peak/122dB continuous
- Sound dispersion at 10dB: H90° x V60°
- Sensitivity: 97dB
- Crossover: 1800Hz

Features

- State-of-the-art 1.34" titanium-diaphragm compression driver for crystal-clear high-frequency reproduction
- Compact and lightweight system delivers distortion-free sound even at max volume
- Green amplifier technology turns over 90% of electricity into usable sound
- Class D amplifier technology offers high-power transparent sonic performance
- Built-in limiter fully protects the speaker from distortion at any volume level and also protects the amplifier from ever getting damaged
- Our custom-engineered limiter allows the speaker to play at crazy-high volumes while limiting the frequencies that sound bad
- 4 DSP sound modes/preset EQ settings (normal, indoor, outdoor, and speech) to accommodate different listening environments and applications
- Built-in reliable Pro Bluetooth with 100-foot range and no distortion
- TWS (True Wireless Stereo) technology allows you to link two speakers wirelessly in stereo
- Custom-tooled aluminum amplifier heat sink stays cool and looks nice
- 2-channel mixer built-in with ultra-low noise Mic/Line inputs via XLR/1/4" combo jacks with volume control
- Balanced line output via XLR for linking additional speaker systems or for adding a subwoofer
- Clip/limit LED indicator makes it easy to set your levels
- Power and signal LED indicators
- Stand mounting with 35-mm pole socket
- Ergonomically shaped handle for easy carrying and setup
- A full-grilled front cabinet perfectly protects speaker against road damage
- Enclosure is made of rugged, drop-tested, high-grade polypropylene construction
- The cabinet has a built-in handle and wheels for easy transporting
- 110-volt use only
- External user-serviceable fuse
- Dimensions of speaker: 15" x 12" x 23.4" (L x W x H)
- Weight of speaker: 38.5Lbs.

Troubleshooting

PROBLEM	SOLUTION
No power	<ol style="list-style-type: none"> 1. Make sure the unit is plugged in and the power switch is in the ON position. 2. Check that the power cable is plugged in tightly to the unit. 3. Check and replace the fuse if necessary. 4. If people or equipment tend to step on and roll over or stretch your power cable, it can get damaged. Always try a second cable to test for shorts in original cable. Dispose of damaged power cables immediately.
No sound/ distorted sound	<ol style="list-style-type: none"> 1. Check that all appropriate cables are plugged in correctly. 2. Check the Levels settings. Refer to the “Setting Level Controls” section on page 4 of this manual for instructions on how to properly adjust the input level controls. 3. Be sure your microphone is on and plugged into the correct input. 4. If using a mixing console, make sure fader and balance are set to center positions and levels are increased. Make sure the mixer is plugged into the correct input. 6. If channel or BT levels settings are maxed out, turn down the appropriate one, as you may be over driving the unit. 7. Check volume and level settings on all input sources.
Buzzing sound	<p>Make sure you are using a proper cable. For ¼” cables, there are three types: instrument, TS (unbalanced), and TRS (balanced). The TITAN 12 accepts both TS and TRS ¼” cables. Check the requirements of the connected gear and make sure you are using the appropriate cable.</p>
Mic feedback	<p>Point the mics away from the speaker. Make sure the mics are behind the speaker, not in front of it.</p>
Poor mic sound	<ol style="list-style-type: none"> 1. Make sure you are using the XLR part of the Mic/Line ports. 2. If using wireless mics, connect them into the Line input of your mixer.
Bluetooth/TWS pairing fails	<ol style="list-style-type: none"> 1. Check to see that both devices are turned on and that your Bluetooth device is discoverable. 2. Turn both devices off and then on again. 3. Make sure you’ve selected the proper source. 4. Make sure that the Bluetooth device is within 5 feet of the unit. 5. Move both devices away from other Bluetooth devices, micro-waves, wireless routers, and other electronics. 6. Make sure that the unit is not paired to a previously paired device or to another speaker. <p>Please refer to pages 6 and 7 for Bluetooth - and TWS - pairing procedures.</p>

Rockwell

FEDERAL COMMUNICATIONS COMMISSION COMPLIANCE INFORMATION

Responsible party name: Rockville

Address: 600 Bayview Ave,
Entrance A,
Inwood, NY 11096

Hereby declares that the product(s) TITAN 12 pro audio speaker complies with FCC rules as mentioned in the following paragraph:

This device complies with Part 15 of the FCC rules. Operation is subject to the following two conditions: (1) this device may not cause harmful interference, and (2) this device must accept any interference received, including interference that may cause undesired operation.

Note: This equipment has been tested and found to comply with the limits for a Class B digital device, pursuant to Part 15 of the FCC rules. These limits are designed to provide reasonable protection against harmful interference in a residential installation. This equipment generates, uses, and can radiate radio frequency energy and, if not installed and used in accordance with the instructions, may cause harmful interference to radio communications. However, there is no guarantee that interference will not occur in a particular installation. If this equipment does cause harmful interference to radio or television reception, which can be determined by turning the equipment off and on, the user is encouraged to try to correct the interference by one or more of the following measures:

- Reorient or relocate the receiving antenna.
- Increase the separation between the equipment and receiver.
- Connect the equipment to an outlet on a circuit different from that to which the receiver is connected.
- Consult the dealer or an experienced radio/TV technician for help.

Rockwell

ROCKWELL

ROCKVILLE

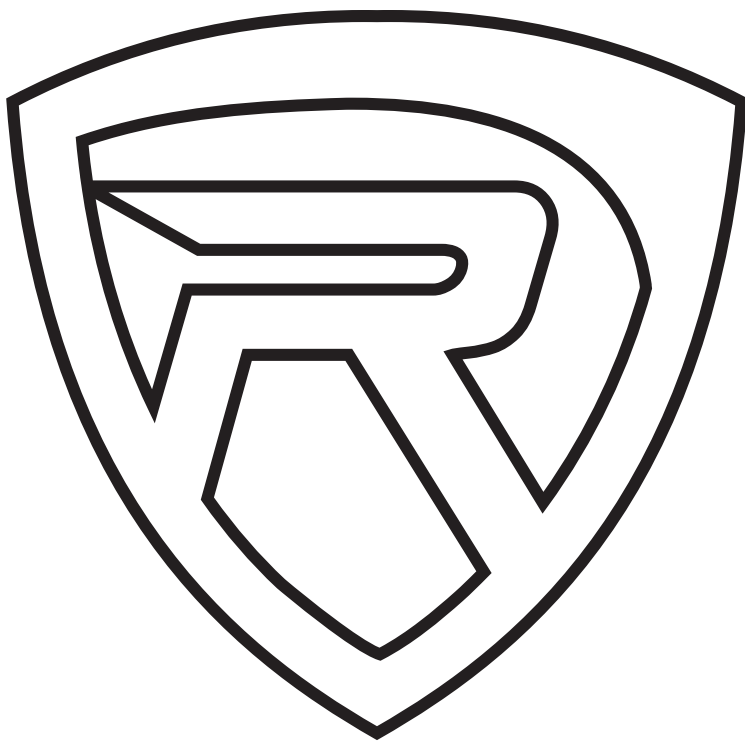

RockvilleAudio.com