

ROCKVILLE

RWM1000 SERIES

HIGH PERFORMANCE WIRELESS
MICROPHONE SYSTEMS

OWNER'S MANUAL

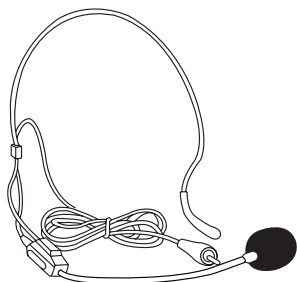
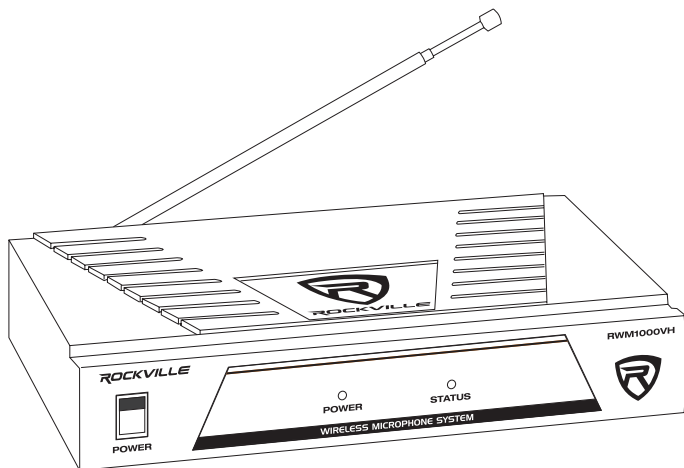

RWM1002VS

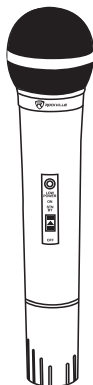

RWM1000VH

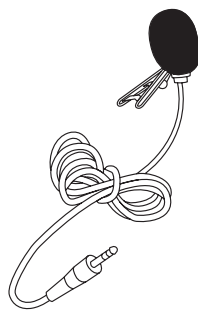

RWM1005VC

Missing items? If you ordered a bundle that includes more than one product and you are missing part of your bundle then it just means your order shipped from two different warehouses. You will receive the remaining items very soon. If you have any concerns or inquiries, feel free to call our customer support center at 1-646-758-0144, 24 hours a day/7 days a week.

Thank you for purchasing this Rockville Wireless Microphone System. Please read this installation guide carefully for proper use of your Rockville Wireless Microphone System. Should you need assistance, please call our technical help line at 1-646-758-0144, 24 hours a day/7 days a week.

Table of Contents

Specs	3
Microphones	4
Body Pack	4
Receiver (Front)	5
Receiver (Back)	5
Setup and Operation, Frequency Groups	6
Troubleshooting	7

Specs

SYSTEM

Operating Range*: 100'– 200'(indoor), 65 – 165'(outdoor)

Audio Frequency Response: 80Hz – 12,000Hz

Dynamic Range: $\geq 80\text{dB}$

Signal-to-Noise Ratio: $\geq 80\text{dB}$

Operating Temperature: 41°F – 113°F

Carrier Frequency Range: 180MHz – 280MHz

RECEIVER

Sensitivity: (S/N=30dB) $> 2\text{mV}$

De-Emphasis: 50 μS

Audio Output Impedance: 600 Ω

Audio Output Level.: 0 – 0.5V

Power Supply: AC110V/50Hz

Current Consumption: $\leq 50\text{mA}$

Audio Out Connector: 1/4" unbalanced

TRANSMITTER

Frequency Stability: $\pm 0.005\%$

RF Output Power: $\leq 30\text{mW}$

Modulation Mode: VHF

Maximum Deviation Range: $\pm 50\text{kHz}$

Microphone Mode: Fixed

Pre-Emphasis: 50 μS

Power Supply: 9V Batt/1.5V $\times 2$

Current Consumption: $\leq 35\text{mA}$

*Operating range is subject to environmental conditions.
Results may vary.

Microphones

- Microphone windscreen
- Power LED indicator
- Power on/off switch
- Battery compartment
- Connector jack

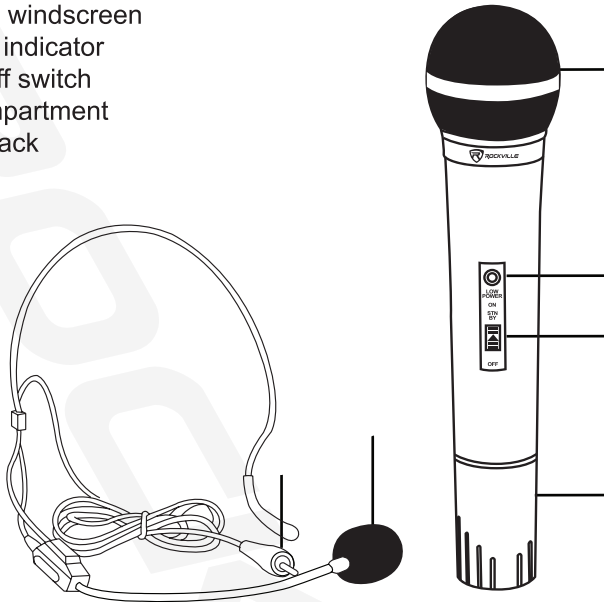

Body Pack

- Power on/off switch
- Microphone input
- Clip
- Microphone
- Gain control
- Power LED - When you power ON the body pack, the LED indicator will flicker and turn off. Upon requiring a battery replacement the LED indicator will remain on.

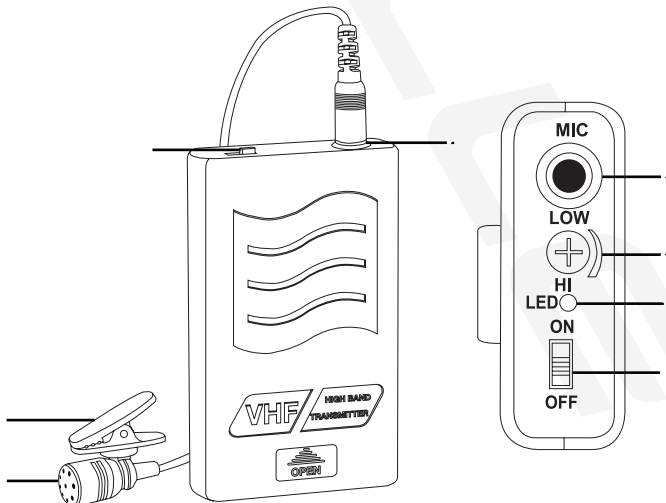

Receiver (Front)

- a. Antenna
- b. Power on/off switch
- c. LED power Indicator
- d. Signal strength status

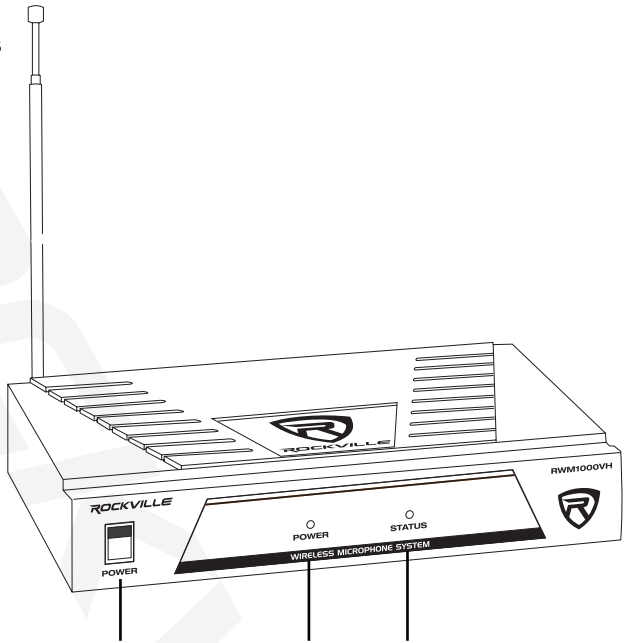

Receiver (Back)

- a. Volume adjustment knob
- b. Audio out (1/4" TRS connection)
- c. Antenna port
- d. Power plug

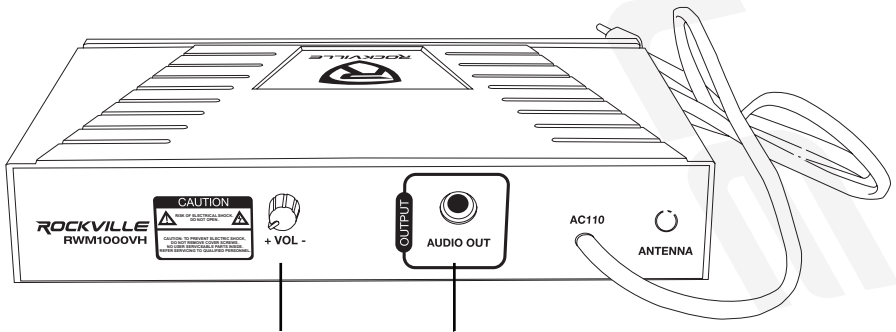

Setup and Operation

For best performance of the wireless microphone system you should make sure that you run the cable from the receiver output (either XLR or ¼" output) into a Microphone input on a powered speaker or mixing board. If you run it right into a line level input then the audio volume level output of the microphone(s) will drop significantly. Most mixers and powered speakers have both a Microphone input and a line level input.

- The receiver should be placed in an area that is stable and least likely to shake the unit.
- The receiver should be at least 3' off the ground for optimal transmission.
- Connect the antenna, balanced cable AF line, and power supply provided.
- The antenna should extend vertically.
- Switch on the receiver.
- While the receiver is in stand-by, switch on the microphones.
- Adjust volume as necessary.
- Use trim adjustment on the body pack to fine tune the mic gain so that the audio output is louder or softer.
- When you power ON the body pack, the LED indicator will flicker and turn off. Upon requiring a battery replacement the LED indicator will remain on.
- When you power ON the microphone, the LED indicator will be on. When the battery gets low, the LED indicator will dim. When the LED indicator is off the microphone needs new batteries.

Tip:

To minimize feedback avoid operating the microphones in close proximity of or in front of speakers.

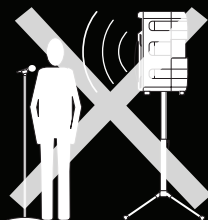
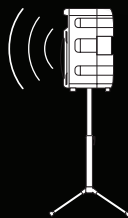

Frequency Groups

- **GROUP A:** 202.90 MHz
- **GROUP B:** 204.40 MHz
- **GROUP C:** 201.80 MHz
- **GROUP D:** 209.10 MHz
- **GROUP E:** 205.30 MHz

Problem	Solution
No sound or faint sound	<ul style="list-style-type: none">• Verify all sound system connections or adjust channel volume as needed.• Verify that the receiver is connected to the mixer/ amplifier.
	<ul style="list-style-type: none">• Turn on transmitter.• Make sure the batteries are installed correctly.• Charge or change battery.
	<ul style="list-style-type: none">• Make sure AC adapter is securely plugged into electrical outlet.• Make sure receiver is powered on.
Audio artifacts or dropouts	<ul style="list-style-type: none">• Identify nearby sources of interference (cell phones, Wi-Fi access points, signal processor, etc...) and shutdown or remove source.• Charge or change transmitter battery.• System must be set up within recommended range and receiver kept away from metallic surfaces.• Transmitter must be used in line of sight from receiver for optimal sound.
Distortion	Reduce transmitter channel volume.
Sound level variations when switching to different sources	Adjust transmitter volume as necessary.

Visit us at:

RockvilleAudio.com