

ROCKVILLE HTS820 Quick Start Guide

Thank you for purchasing this Rockville HTS820 Home Theater System. Please read this quick start guide carefully for proper use of your HTS820. Should you need assistance, please call our technical help line at 1-646-758-0144, 24 hours a day/7 days a week.

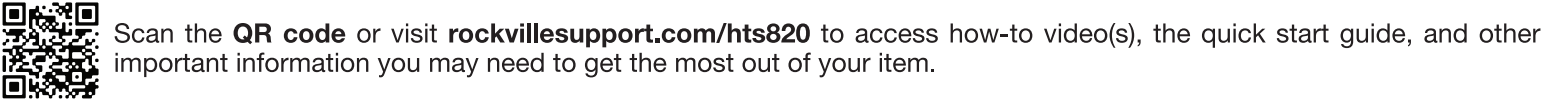

1 FEATURES/FUNCTIONS/ACCESSORIES

REAR PANEL and REMOTE

1. FM Radio/USB/SD/Bluetooth Controls
 - a. **II**: Press and hold to initiate automatic station search in FM mode. In USB/SD/BT mode, press to pause or play audio. In BT mode, press and hold to force disconnect a device or to force pair a previous device.
 - b. **CH+/II**: Press for next FM station or next track in USB/SD/BT mode. In USB/SD mode, press and hold to fast forward.
 - c. **CH-/II**: Press for previous FM station or previous track in USB/SD/BT mode. In USB/SD mode, press and hold to rewind.
2. 5.1/2.1: Press to toggle between 5.1 and 2.1 mode.
3. Optical Audio Input
4. ARC Input
5. Audio outputs to other satellite speakers
6. SD Card Input
7. DVD Audio Outputs
8. AUX Audio Input
9. FM Antenna Port
10. USB Input
11. Master Volume/Mode: Turn the knob to adjust the system's volume. Press to toggle through the input modes: Aux, FM, USB, SD, Bluetooth, ARC, OPTICAL, and DVD. Press and hold to place the unit in standby mode.
12. 1/4" Mic Inputs
13. Input Voltage Selector Switch: 110V/60Hz or 220V/50Hz
14. Power switch
15. Power cord
16. Standby
17. INPUT: Press to toggle through the input modes: Aux, FM, USB, SD, Bluetooth, ARC, OPTICAL, and DVD.
18. MUTE (front panel will flash when muted)
19. 5.1/2.1: Press to toggle between 5.1 and 2.1 mode.
20. SAVE: Press to save stations to the unit's memory.
21. SLEEP-/+: Press to set sleep mode time (will go into standby if there is no signal input for the amount of time you set).
22. TUNE+/-: Press to manually tune FM stations.
23. AUTO/II: Press and hold to initiate automatic station search in FM mode. In USB/SD/BT mode, press to pause or play audio. In BT mode, press and hold to force disconnect a device or to force pair a previous device.
24. CH+/II: Press for next FM station or next track in USB/SD/BT mode. In USB/SD mode, press and hold to fast forward.
25. CH-/II: Press for previous FM station or previous track in USB/SD/BT mode. In USB/SD mode, press and hold to rewind.
26. FL-/+: Front left speaker volume control
27. FR-/+: Front right speaker volume control
28. CEN-/+: Center speaker volume control
29. SW-/+: Subwoofer volume control
30. VOL-/+: Master volume control
31. SL-/+: Surround/Rear left satellite speaker volume control

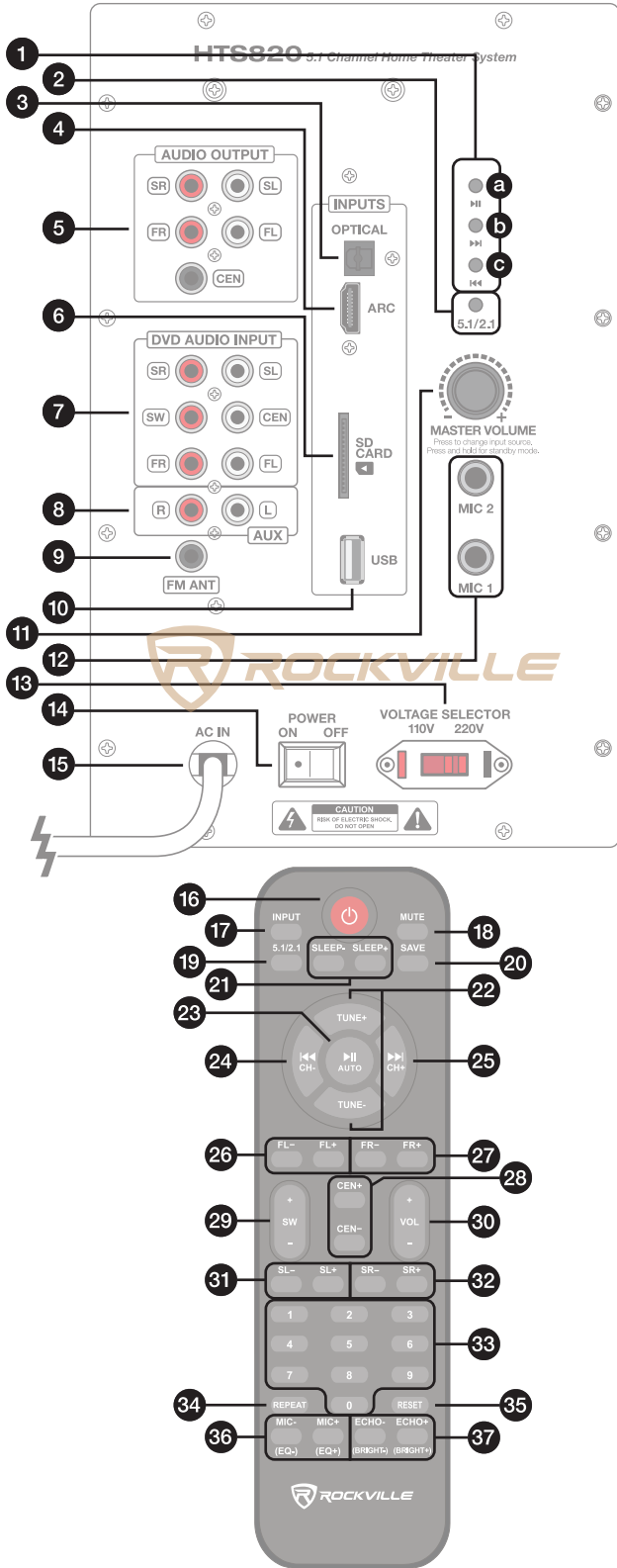

REAR PANEL and REMOTE (continued)

32. SR-/+: Surround/Rear right satellite speaker volume control
33. Number pad: Used to directly select tracks in USB/SD mode or channel presets in FM radio mode.
34. REPEAT: Press to toggle between repeat modes: repeat single song/repeat all songs/shuffle.
35. RESET: Resets all setting to default.
36. MIC-/+ (EQ-/+): When microphones are connected, press these buttons to control the microphones' volume. In USB/SD/BT mode, press to navigate 5 preset EQ curves and to exit EQ mode. Connecting mics will override the ability to change EQ settings, but the unit will keep your EQ settings.
37. ECHO -/+ (BRIGHT -/+): When microphones are connected, press these buttons to control the echo effect. If no microphones are connected, press to adjust the display's brightness. Connecting mics will override the ability to change brightness settings.

INCLUDED ACESORIES

- 8" Subwoofer with built-in receiver
- (2) Front speakers with 12 foot cables
- (2) Rear speakers with 30 foot cables
- (1) Center channel speaker with 10 foot cable
- Satellite Speaker Mounting Kits
- Remote Control
- Dual RCA to dual RCA cable
- Dual RCA to 3.5mm cable
- Dual female to male 3.5mm cable
- FM Antenna Cable
- Manual
- Warranty Card

2 SETUP

SPEAKER PLACEMENT

1. Most people place the subwoofer in the front of the room, near the sound input source, for ease of connection. But since bass frequencies are omnidirectional the subwoofer can be placed anywhere. Try placing it near a wall or a corner for increased bass.
2. The center channel speaker should be placed directly in front of the listening position, above or below the sound input source. If possible, tilt it as necessary to direct the sound to ear level.
3. Mount the front speakers on the wall, directly to the left and right of the center channel speaker. Angle them towards the listening position. Preferably, the tweeters should be at ear level.
4. Mount the satellite speakers on the wall, slightly behind the listening position, about 1 to 2 feet above ear level or at ear level if height adjustment is not possible. If rear placement is not possible you can place them on the side facing towards the listener or even forward slightly towards the listener if needed.

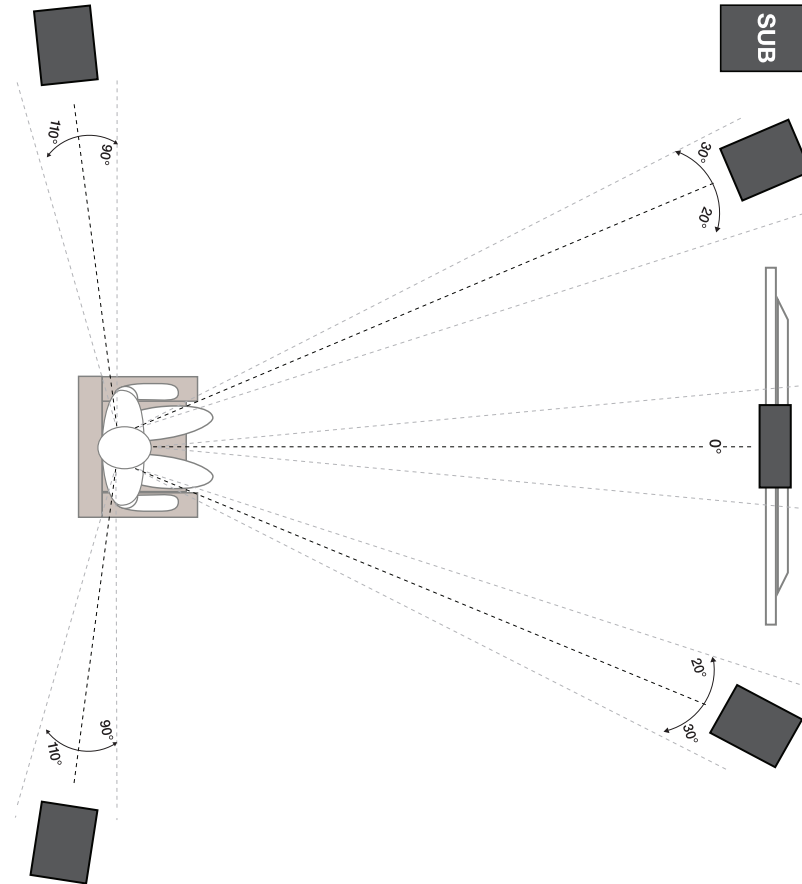

2 SETUP (continued)

SPEAKER MOUNTING

Before you begin please make sure you have the proper tools and necessary accessories. For this installation you will need the following items:

- Wall screws (included), wall hooks (optional, not included), an electric drill, and a Phillips screw driver.

Attention! Be sure to wire each speaker before mounting it to the wall.

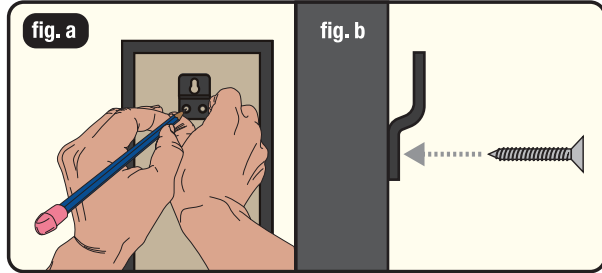
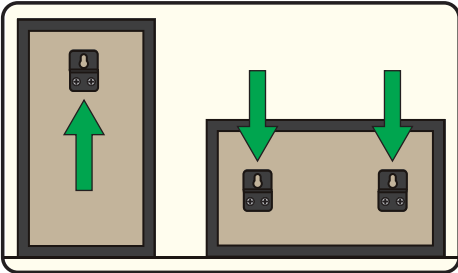

1. Attach the speaker mounting brackets on the same locations as shown above. Begin by marking the spot where the bracket will be installed. Use the bracket as a template (fig. a). Attach the bracket using the included screws (fig. b). Repeat these steps for the other speakers.

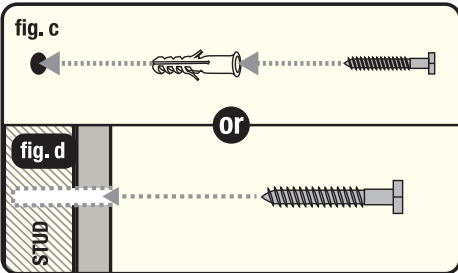

2. We recommend using wall anchors (fig. c; not included) or drilling into a stud (fig. d). If you are using anchors, make sure the holes are deep enough to accommodate them.

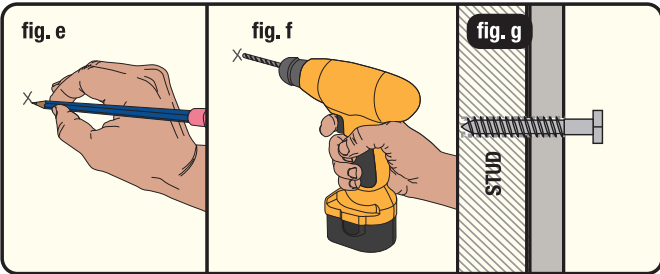

3. Make marks on the walls where you wish to mount the speakers (fig. e). If mounting to a stud, use a stud finder to locate the stud. Make sure that there are no wires or cable lines located in that area. Using a drill, make holes where you made your marks (fig. f). Insert the screw, but leave at least a quarter inch of the screw's head out (fig. g).

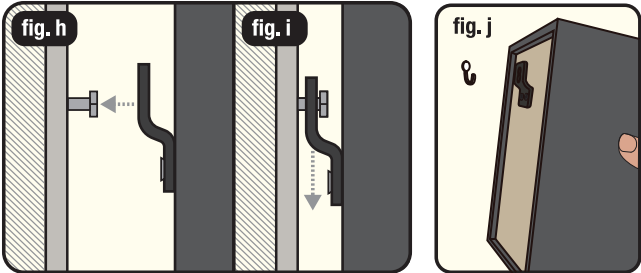

4. Once the mounting screws are in place, lift the speaker, align the screw with the bracket's mounting hole, and slide onto the screw (fig. h). Now tug the speaker down slightly to ensure that it is seated properly (fig. i). Repeat these steps for your other speakers. You can also use a mounting hook (fig. j) to hang the speaker.

3 AUDIO INPUT/OUTPUT

AUDIO OUTPUT

Place speakers in the desired position (see speaker positioning diagram) and connect the center, front, and satellite speakers to the corresponding Audio Output RCA plugs on the subwoofer unit as shown below.

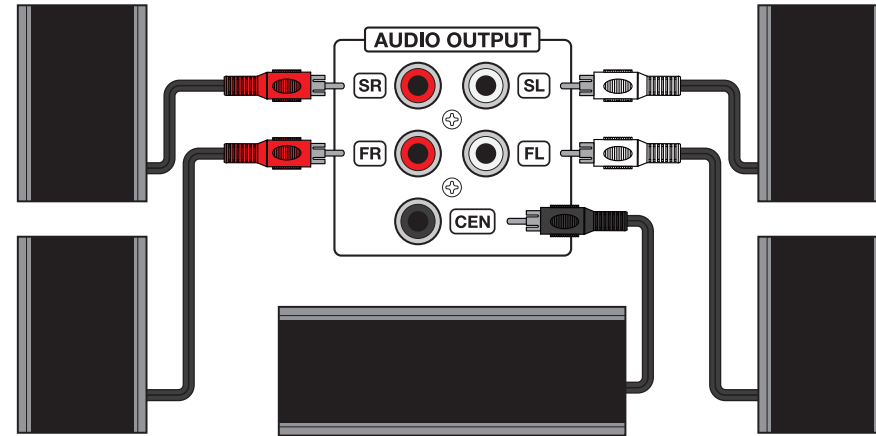

BT INPUT

1. Set the HTS820 unit to BT mode by pressing the Master Volume multi-function button on the back of the subwoofer unit or by pressing the input button on the remote control until the LCD screen reads BT.
2. Turn on the Bluetooth feature on your device and ensure that it is discoverable. Look for and select HTS820 from your Bluetooth device's list of available BT devices.
3. Playback, track selection, and volume can be controlled from the back panel of the subwoofer unit or the remote control.
4. To unpair a currently paired device or force pair a new device, press and hold the **BT** on the back of the subwoofer unit or **AUTO/▶** button on the remote control.

OPTICAL/ARC and USB/SD INPUTS

Use the optical and ARC inputs to connect a TV, Digital set-top boxes, Home Theater receivers, game consoles, DVD players, Blu-ray players, CD players, etc.

Use the USB and SD inputs to connect any USB drive or SD card with a max capacity of 64GB.

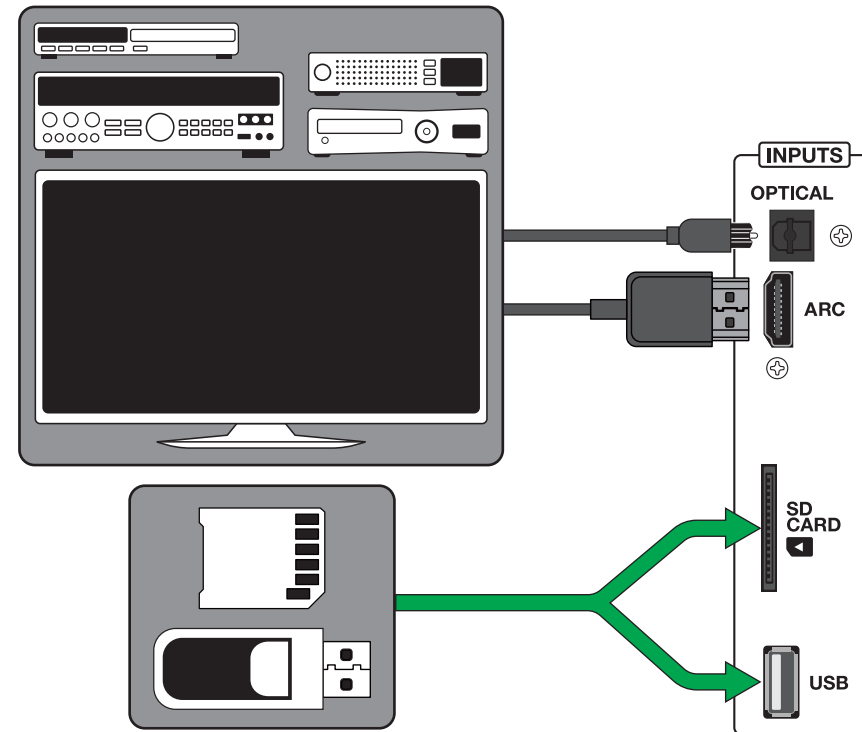

DVD AUDIO INPUT

Use these RCA jacks to input the sound signal from any 5.1 channel output enabled source such as a TV, Digital set-top boxes, game consoles, DVD players, Blu-ray players, CD players, etc.

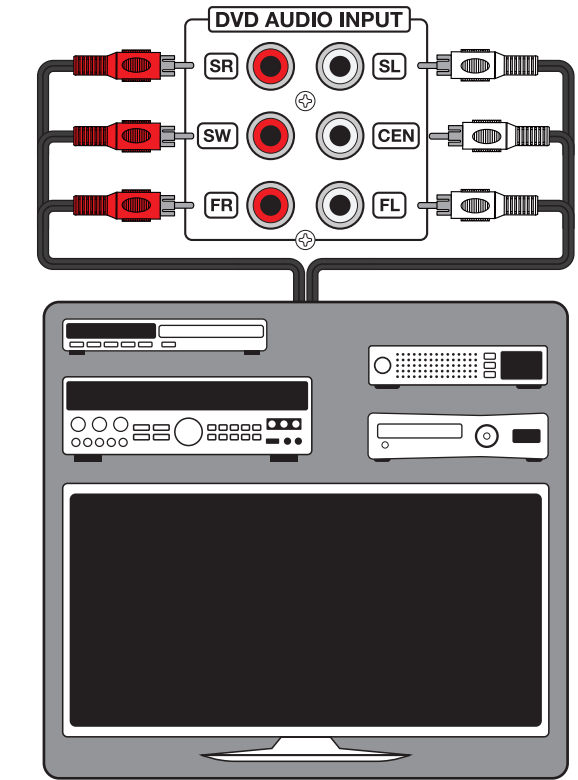

AUX AUDIO INPUT

Use the RCA Auxiliary jacks and the included dual RCA to dual RCA cable to connect computers, cellphones, MP3 players or any other external sound source. Some devices may require an RCA to 3.5mm Y adapter (included).

