

ROCKVILLE

D12

5000-WATT PRO RACK AMPLIFIER

OWNER'S MANUAL

ATTENTION: WATCH THIS VIDEO BEFORE FIRST USE!

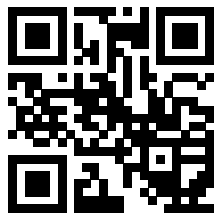

Scan the **QR code** or go to **rockvillesupport.com/d12** for essential information, guides (video and/or written), and tips to make the most out of your purchase.

If you prefer written instructions, please read ahead!

With Rockville you get many options.

Missing items? If you ordered a bundle that includes more than one product and you are missing part of your bundle then it just means your order shipped from two different warehouses. You will receive the remaining items very soon. If you have any concerns or inquiries, feel free to call our customer support center at 1-646-758-0144, 24 hours a day/7 days a week.

Thank you for purchasing this Rockville product. Please read this installation guide carefully for proper use of your Rockville D12 Pro Amplifier. Should you need assistance, please call our technical help line at 1-646-758-0144, 24 hours a day/7 days a week.

IMPORTANT SAFETY INSTRUCTIONS



TO REDUCE THE RISK OF ELECTRICAL SHOCK, NEVER OPEN THE UNIT. THERE ARE NO SERVICEABLE PARTS INSIDE. WE RECOMMEND CONTACTING ROCKVILLE FOR ANY REPAIRS.

- Do not expose this unit to any kind of moisture.
- Please ensure that the unit is situated in a properly ventilated area.
- Make sure cooling fan vents are free of obstructions.
- Replace fuse with one of the same type, size, and rating only.
- Do not attempt to operate this unit if the power cord has been frayed or broken.
- Do not attempt to break off or remove the ground prong. This prong is used to reduce the risk of electrical shock and fire in case of an internal short.
- Do not operate this unit if it is damaged.
- This unit is intended for indoor use only.
- Always mount this unit in a safe and stable manner.
- Power supply cords should be routed so that they are not likely to be walked on or pinched by items placed on or against them, paying particular attention to the point of exit from the unit.
- To avoid unnecessary wear and to improve the unit's lifespan, unplug the unit when not in use for extended periods of time.

Features

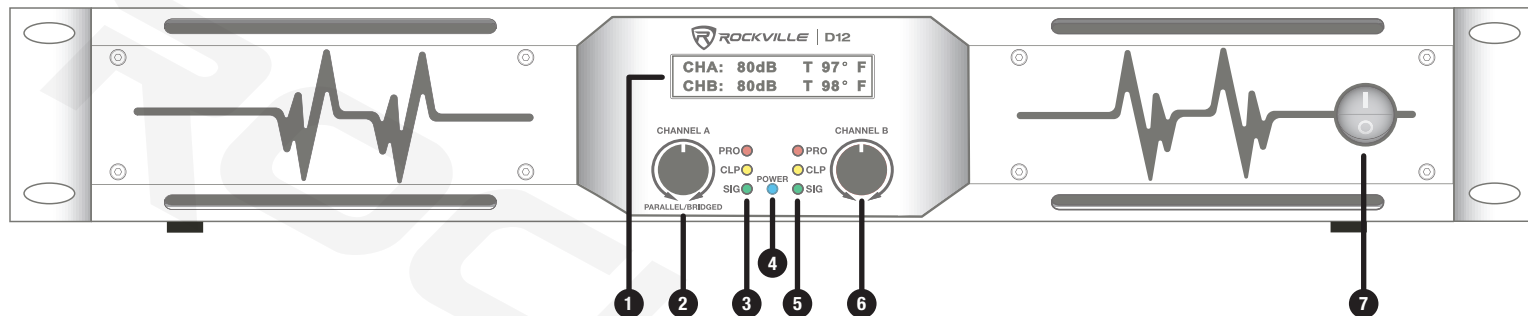

1. LCD Screen: Displays signal level and temperature for each channel.
2. Channel A Signal Level Adjustment Knob: Controls the level of incoming signal. Turn the knob counterclockwise if the Clip LED remains on for more than 5 seconds (indicating the input signal is too strong).
3. Channel A LEDs:
 - Clip** - Indicates that the amplifier's output is within 3dB of clipping. Occasional blinking is acceptable, but if it remains on for more than 5 seconds, you should turn down the level controls or reduce the output level of the input source to avoid audible distortion.
 - Signal** - Indicates that there is an input signal greater than 100mV.
 - Protect** - Indicates that the output connection is shorted, the load impedance is too low, or there is an internal malfunction.
4. Power LED: Indicates the power is turned on.
5. Channel B LEDs: See item 3 above.
6. Channel B Signal Level Adjustment Knob: See item 2 above.
7. Power On/Off Switch

Features (continued)

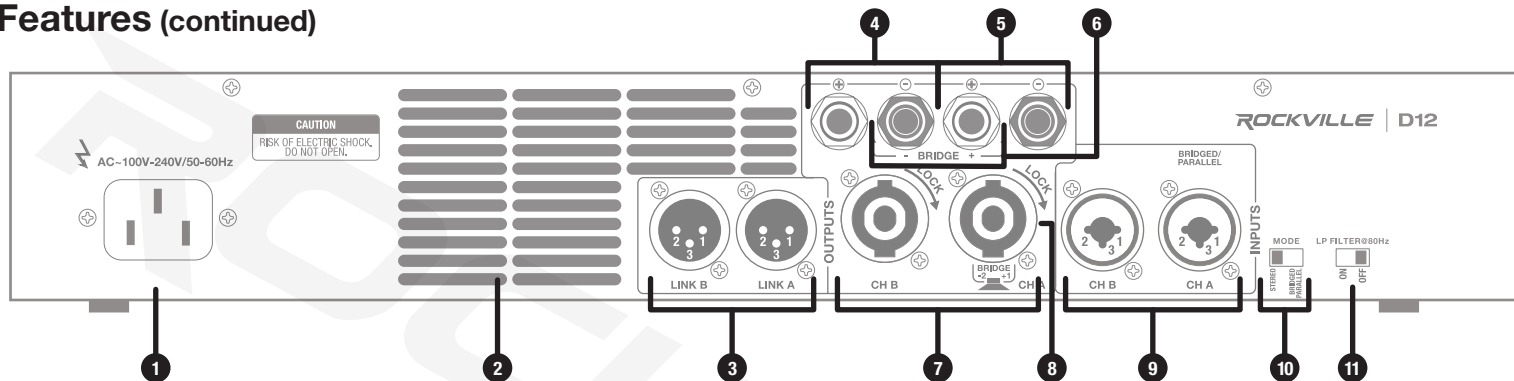

1. AC 100 – 240V/50 – 60Hz power input
2. Built-in automatic variable-speed high-velocity cooling fan
3. Channel A/B XLR Link Out
4. Channel B Binding Post/Banana Plug outputs
5. Channel A Binding Post/Banana Plug outputs
6. Channel A/B Binding Post/Banana Plug bridged output

7. Channel A/B Speakon outputs
8. Bridged Speakon output
9. Channel A/B XLR /1/4" TRS/TS combo inputs
10. Mode switch: stereo or bridged/parallel
11. 80Hz Low Pass Filter on/off switch

Setup

Rack Mounting

The D12 was designed for standard 19" rack mounting and requires a 1.5U rack space. Use the appropriate screws and washers (not included) to mount the amp to the front rack rail. Preferably, the side wall should be at least 2" from the sides of the amplifier and the back of the rack should be open. This will ensure a source of cool air to all sides. Be sure to support the rear of the amp, especially for mobile use during which it will be subjected to strong vibrations. These amps can also be "stack" mounted without a cabinet.

Configurations

Crossover and Mode Switches

In STEREO mode the amplifier is fed a full-range signal and outputs a specific left and right signal. Each channel is fully independent and has a separate level control. *Make sure the speakers' impedance is no less than 4 ohms.*

In BRIDGED/PARALLEL mode, the channels are connected internally and Channel A is the dedicated input. The Channel A signal level adjustment knob will act as the output level control for both channels.

PARALLEL - The signal input to Channel A will feed a mono signal to both channels.

BRIDGED - The amplifier operates as a one-channel mono amp. The power from both channels is combined into one channel. The signal input to Channel A will feed a mono signal to the Channel A speakon output or the Channel A positive binding post output and the Channel B negative binding post output. The Channel B negative output is connected to the negative input of your speaker. The Channel A positive output is connected to the positive input of your speaker. This mode is primarily used when connecting subwoofers. When bridging, the minimum impedance is 8 ohms.

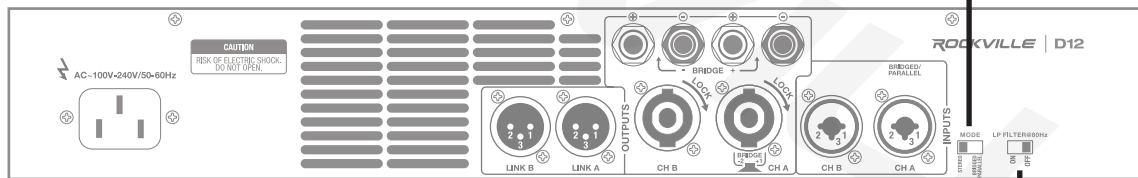

Set the switch to OFF when using full-range speakers.

Set the switch to ON when using subwoofer(s). This will allow frequencies below 80Hz only.

Configurations (continued)

Stereo

! WARNING: Total impedance of your speakers must not be less than 4 ohms.

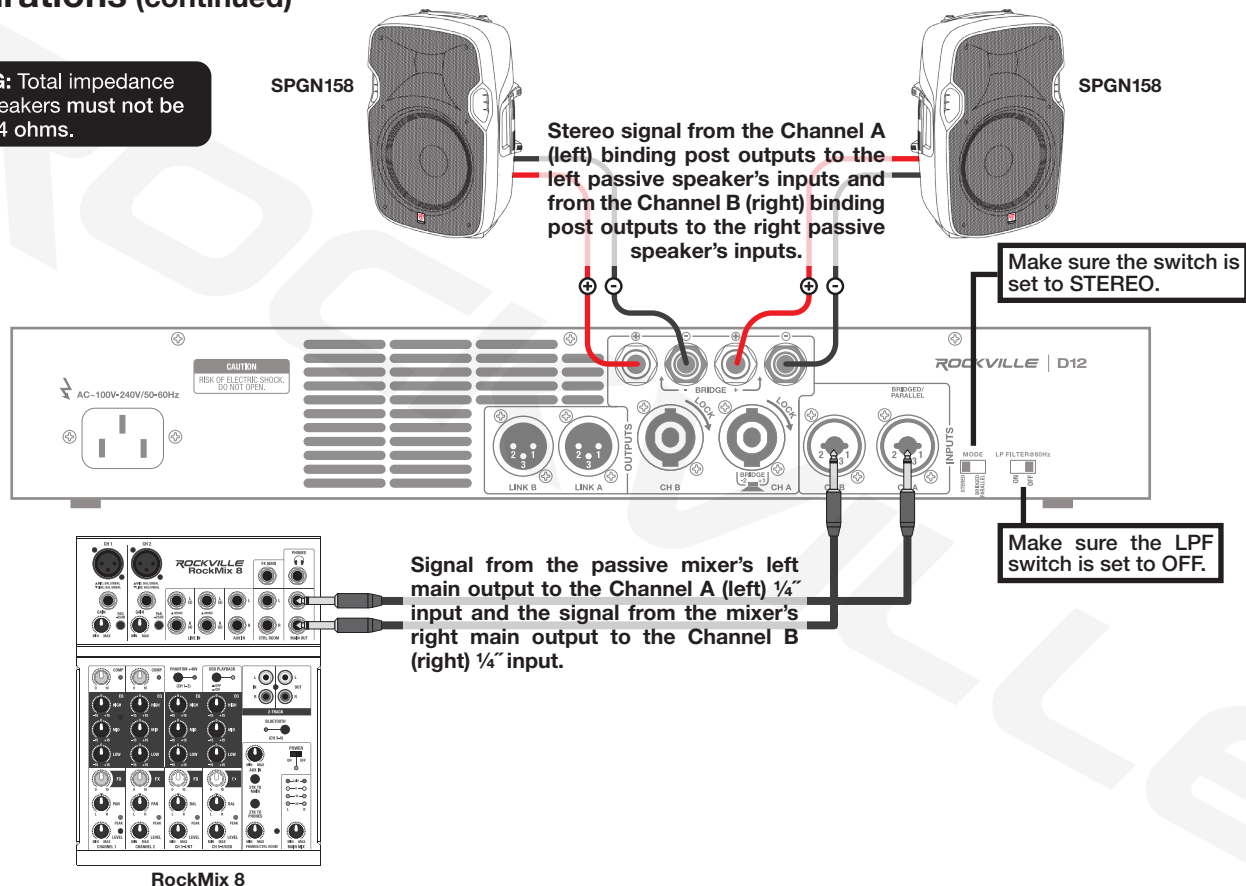

Parallel (mono to speakers via speakon)

! WARNING: Total impedance of your speakers must not be less than 4 ohms.

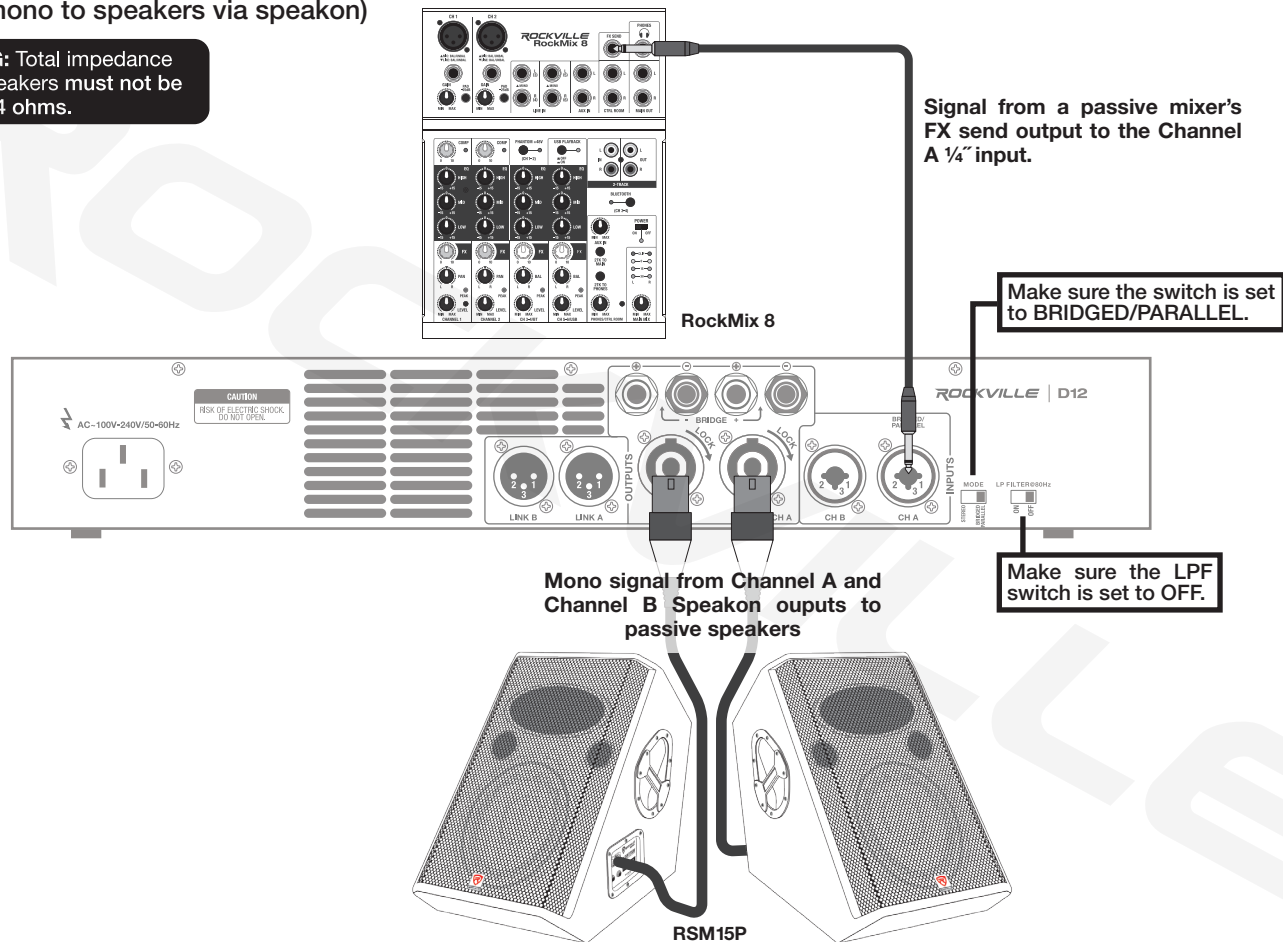

Configurations (continued)

Parallel (mono to speakers via binding posts)

! WARNING: Total impedance of your speakers must not be less than 4 ohms.

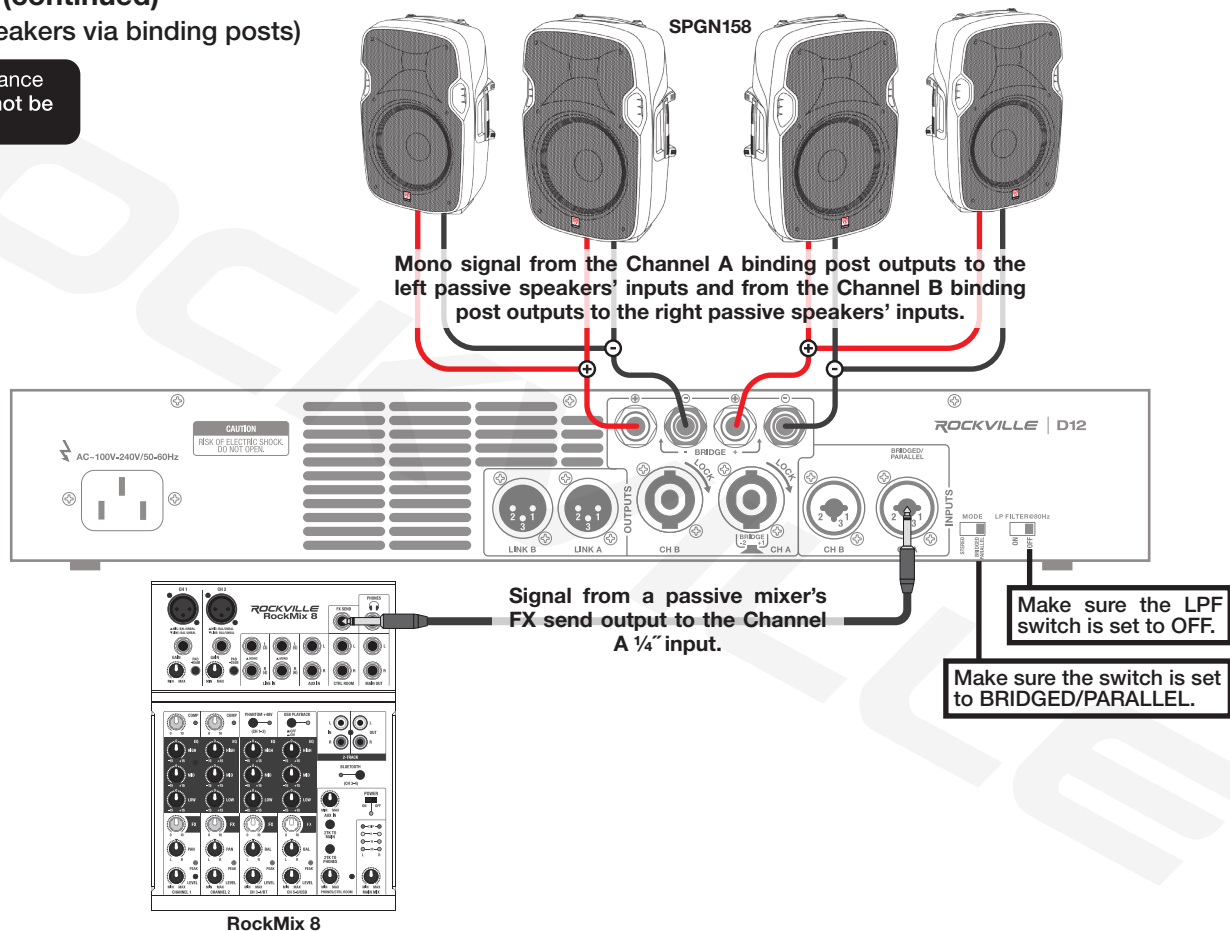

Parallel (mono to subwoofers)

! WARNING: Total impedance of your speakers must not be less than 4 ohms.

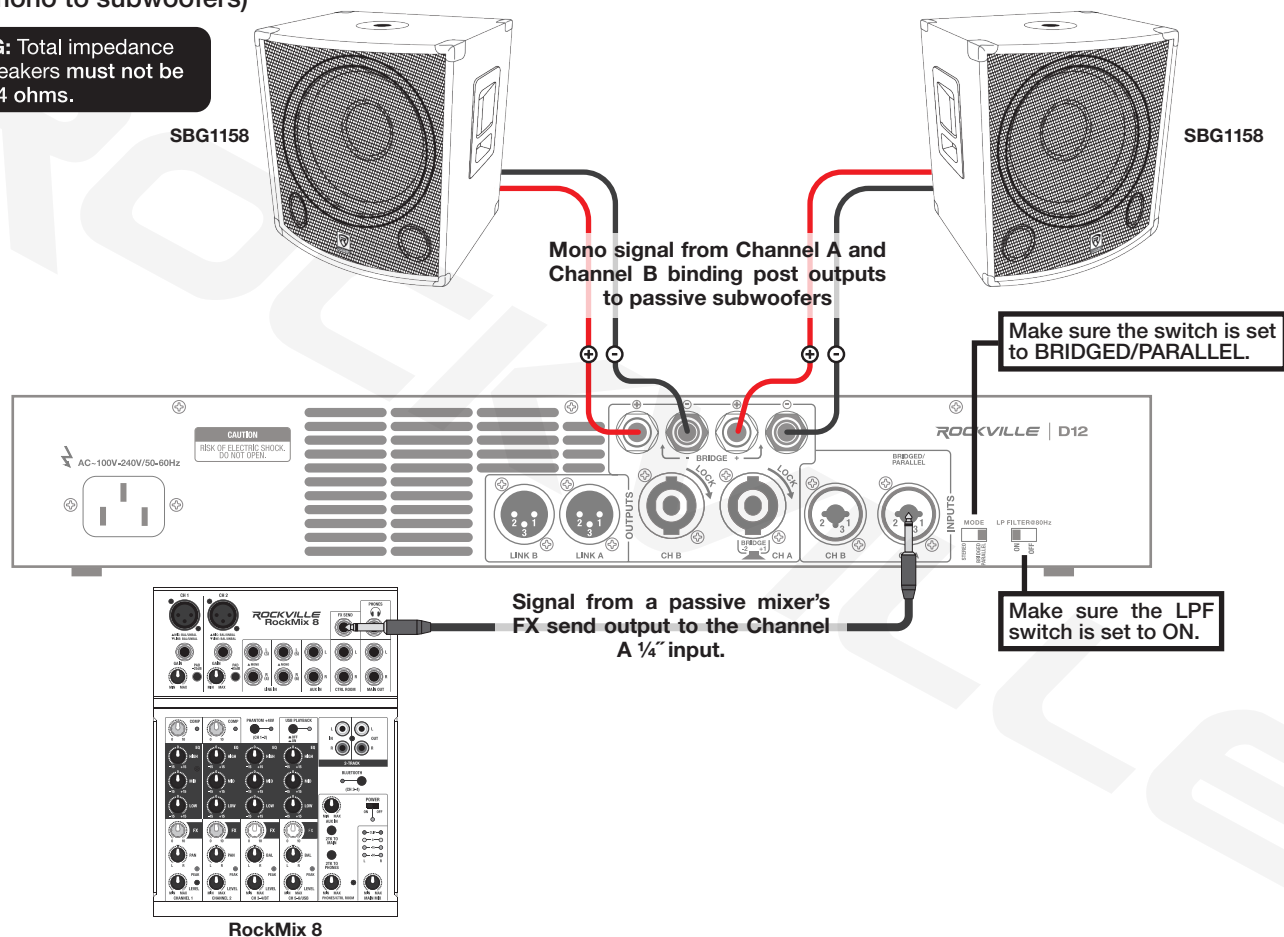

Configurations (continued)

Bridged (mono)

! WARNING: Total impedance of your speakers must not be less than 4 ohms.

Mono signal from Channel A positive (+) and Channel B negative (-) binding post outputs to an 8Ω passive subwoofer

SBG1158

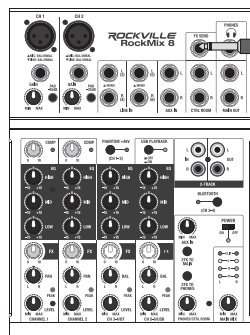
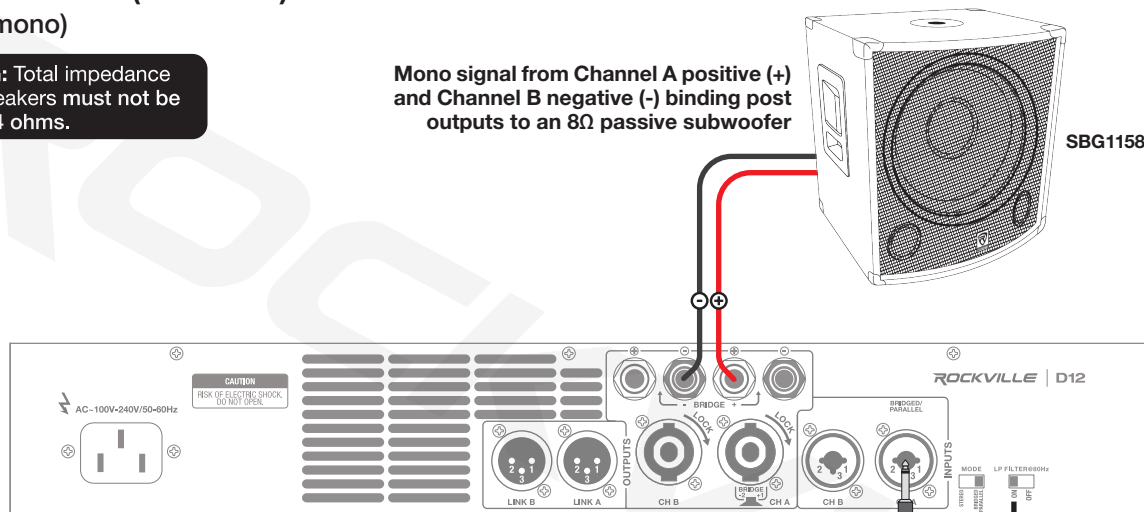

RockMix 8

Signal from a passive mixer's FX send output to the Channel A 1/4" input.

Make sure the LPF switch is set to ON.

Make sure the switch is set to BRIDGED/PARALLEL.

Link Out XLR

These setups allow you to use the amplifier's XLR Link outputs to send the full-range signal from the main amp to a secondary amp (Diagram A) as shown below, directly to a powered sub (Diagram B on page 12), or to a pair of powered PA speakers (Diagram C, page 12).

DIAGRAM A

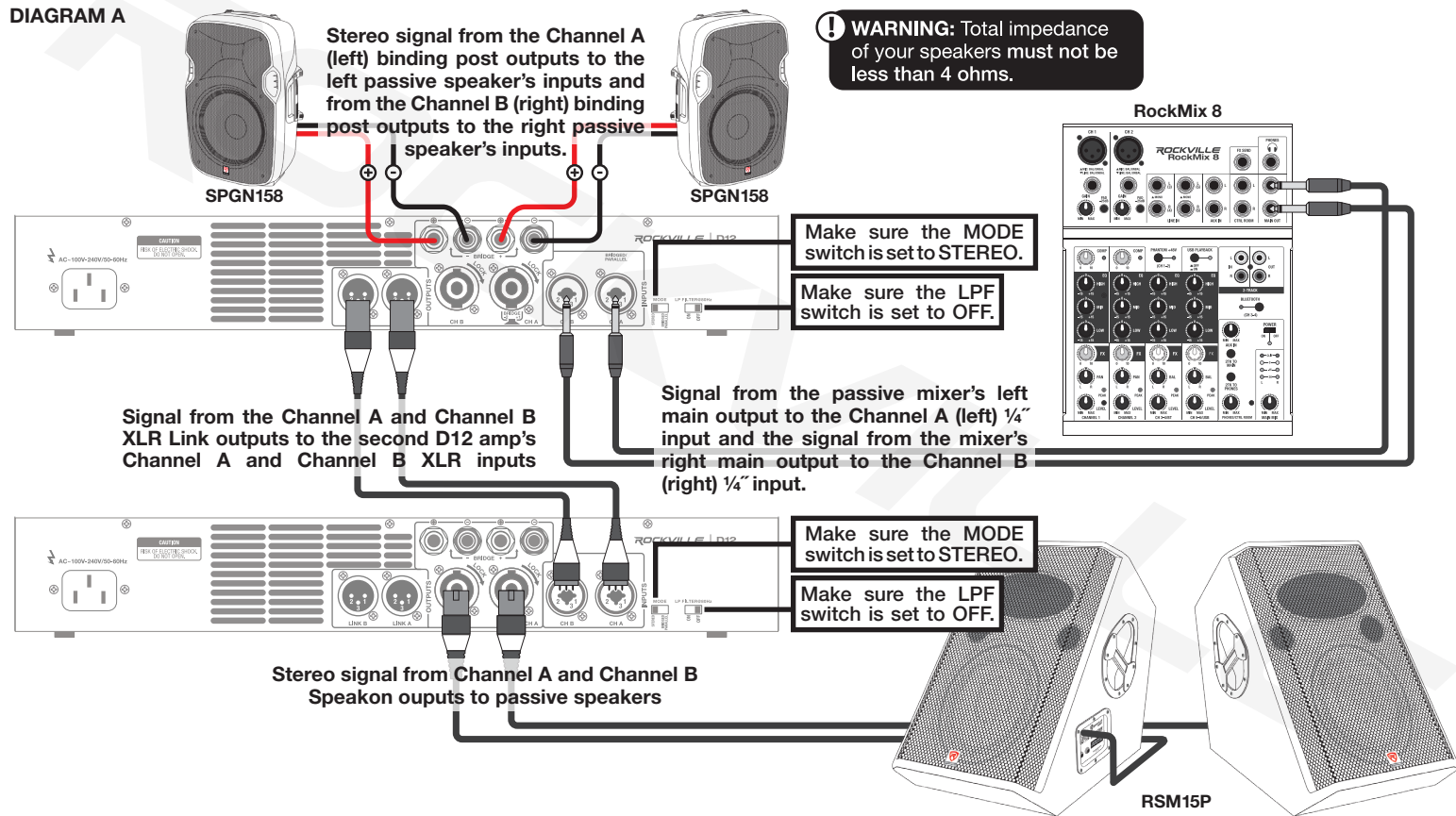

Configurations (continued)

DIAGRAM B

! WARNING: Total impedance of your speakers must not be less than 4 ohms.

SPGN158

Stereo signal from the Channel A (left) binding post outputs to the left passive speaker's inputs and from the Channel B (right) binding post outputs to the right passive speaker's inputs.

SPGN158

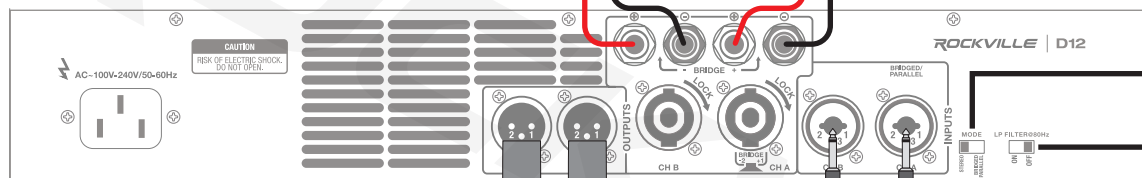

Make sure the MODE switch is set to STEREO.

Make sure the LPF switch is set to OFF.

Signal from the Channel A and Channel B XLR Link outputs to an active subwoofer.

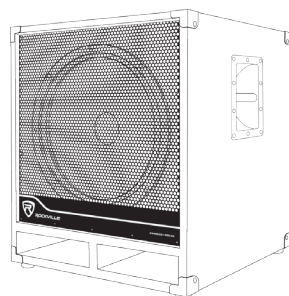

RBG155

Signal from the passive mixer's left main output to the Channel A (left) 1/4" input and the signal from the mixer's right main output to the Channel B (right) 1/4" input.

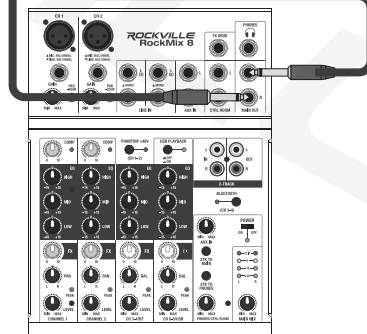

RockMix 8

DIAGRAM C

! WARNING: Total impedance of your speakers must not be less than 4 ohms.

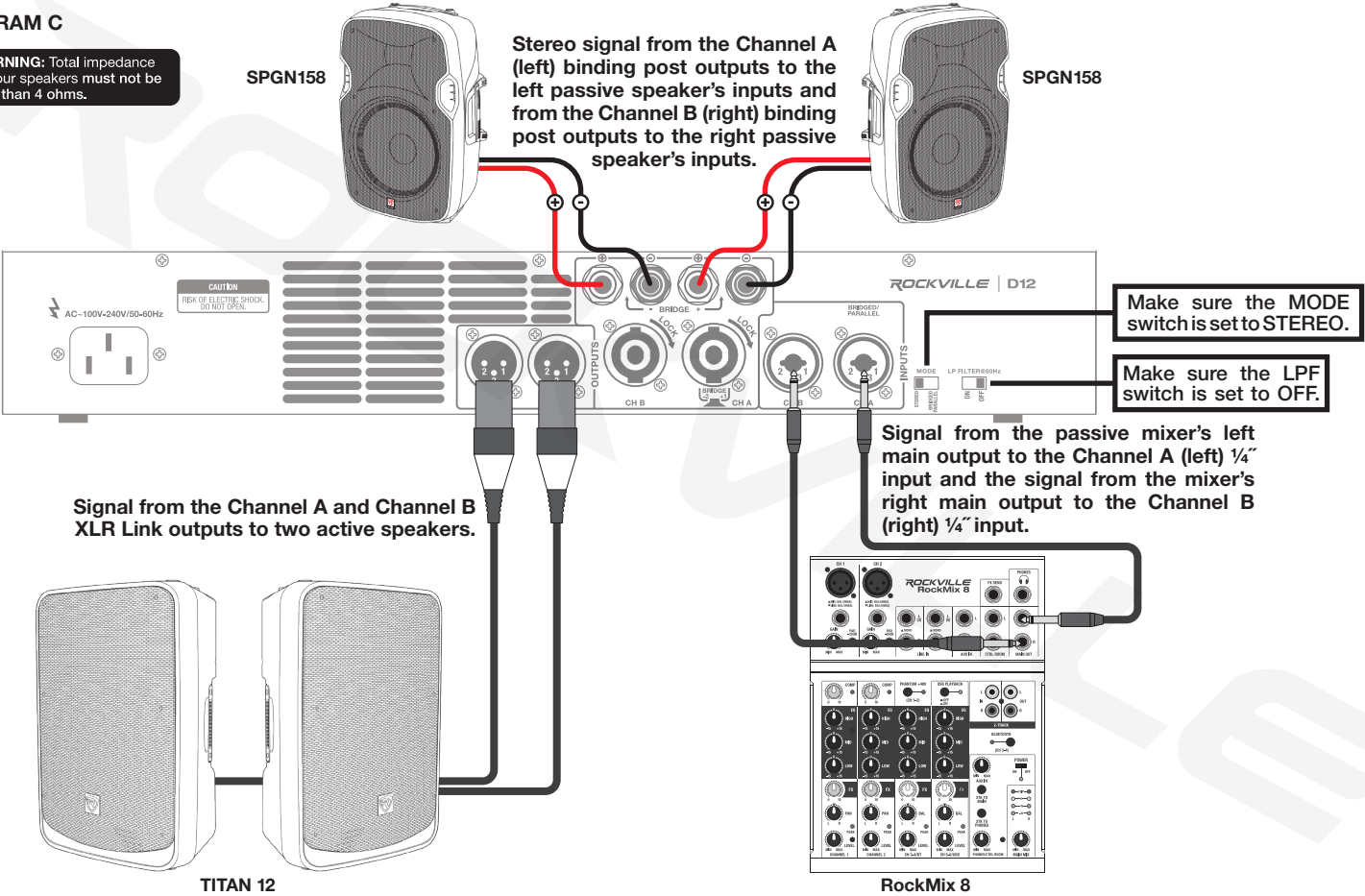

Features/Specifications

- **RMS Power Output:** Stereo 8 Ohm: 2 x 500W
Stereo 4 Ohm: 2 x 700W
Bridged 8 Ohm: 1 x 1400W
- **Peak Power Output:** Stereo 4 Ohm: 2 x 2500W Max
Bridged 8 Ohm: 1 x 5000W Max
- Rockville D12 Class D 2-Channel Power Amplifier
- LCD displays volume in dB per channel and operating temperature
- 1.5U rack space
- Built-in limiter protects your speakers from distortion and clipping
- Stereo mode is perfect for two or four speakers in a left/right configuration
- Bridged/Parallel mode allows you to combine both channel's power into one channel for use with a subwoofer (bridged) or gives you a dual mono output signal, which is perfect for monitor use when you want all sounds coming out of each speaker instead of a L/R configuration
- Built-in 80Hz Low Pass Filter (with on/off switch) allows amp to be used with full-range PA speakers (off) or subwoofer(s) (on)
- Channel A & B individual power, signal, clipping, and protection LED indicators on the front of the amp
- Channel A & B individual level controls for precise setting and matching of sensitivity
- Heavy-duty rack mount ears
- Built-in variable high-velocity quiet cooling fans
- Maximum headroom for 4-ohm and 8-ohm speakers
- Computer-controlled IC protection circuit protects against speaker short circuit, thermal overload, and DC overload
- Frequency Response (bandwidth @ 2Vrms out, @ -3.0dB) 10Hz – 30Khz
- THD + Noise @ 1Khz full power: <0.11%
- Input Impedance: 10K Ohm Balanced
- Input signal voltage: 638mV – 2.7V
- Input sensitivity: 0.7v
- Damping factor (100Hz, 10w, 4 ohms): 43.6
- Damping factor: (1Khz @ 8 ohm): >400:1
- Effective damping factor (100Hz, 10w, 4 ohms): 1.08

- Output impedance at speaker terminals: 0.0918 Ohms
- Frequency Response vs THD+N (worst case, across normal bandwidth 1W) 0.05%
- Signal to Noise Ratio: >100dB
- SLEW RATE (input filter limited): 40v/uS
- Power Requirements: 100V – 240V/50 – 60Hz
- Weight: 9.7Lbs
- Dimensions: 19.09" x 9" x 2.56"

Terminals

- Input Terminals: Combo jack (XLR and 1/4") A & B inputs
- Output Terminals: A & B Banana binding post speaker outputs, A & B Speakon outputs, A & B XLR Link outputs to connect another amplifier or powered sub

Troubleshooting

PROBLEM	SOLUTION
No power	<ol style="list-style-type: none"> 1. Make sure the unit is plugged in and the power switch is in the ON position. 2. Check that the power cable is properly plugged into the wall socket. 3. If people or equipment tend to step on and roll over or stretch your power cable, it can get damaged. Check the power cable for damage. If the cable is damaged, discontinue using the unit until the cable can be repaired.
No sound	<ol style="list-style-type: none"> 1. Check that all appropriate cables and wires are plugged in correctly. 2. Check the channel level settings. 3. Check the volume settings on your input devices. 4. Check mixer's master and input volumes. 5. Make sure you are using the proper cables. 6. Make sure speakers are connected to the amp's OUTPUT, not INPUT. 7. Make sure mixer is connected to the amp's INPUT, not OUTPUT. 8. Make sure the mixer's mute isn't on.
Clipping light is on	<ol style="list-style-type: none"> 1. Turn down signal level controls (gain). 2. Check impedance of speakers or subs.

ROCKVILLE

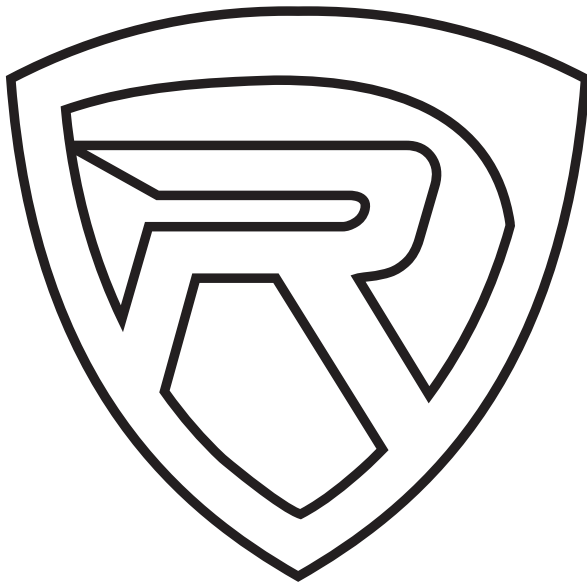

RockvilleAudio.com

© 2026 ROCKVILLE // Features and specifications are subject to change and/or improvement without notice.